

DVB-T TELEVISION 17 & 23

the bathroom television

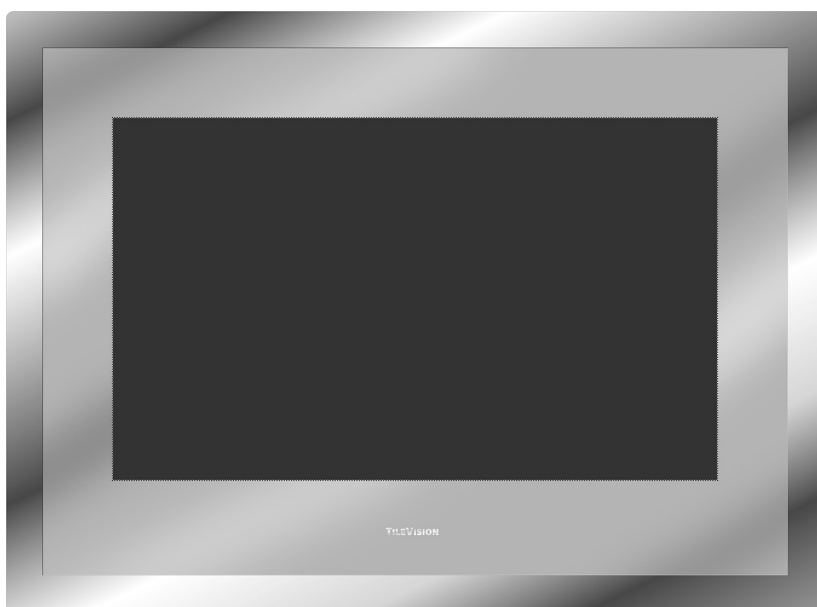

DVB[™]
Digital Video
Broadcasting

digital 
Approved product

HD
ready

HDMI[™]
HIGH-DEFINITION MULTIMEDIA INTERFACE

SRS 
WOW
DIGITAL

DVB-T TILEVISION® 17 & 23

the bathroom television

	CAUTION RISK OF ELECTRIC SHOCK DO NOT OPEN	
<p>WARNING: TO PREVENT INJURY, THIS APPARATUS MUST BE SECURELY ATTACHED TO THE WALL IN ACCORDANCE WITH THE INSTALLATION INSTRUCTIONS.</p> <p>CAUTION: DO NOT REMOVE COVER. NO USER-SERVICEABLE PARTS INSIDE. REFER SERVICING TO QUALIFIED SERVICE PERSONNEL. BEWARE OF STATIC SENSITIVE PARTS.</p>		



The HD ready logo is a trademark of EICTA

This symbol is intended to alert the user to the presence of important operating and maintenance (servicing) instructions in the literature accompanying the appliance. CE

Waste Electrical and Electronic Equipment (WEEE) Directive
In the European Union, this symbol indicates that this product should not be disposed of with household waste. It should be deposited at an appropriate facility to enable recovery and recycling.

This product contains Electrical/Electronic Parts which are produced using components in compliance with the requirements of: European Union Directive **2002/195/EC** for the Restriction of the use of certain Hazardous Substances in Electrical and Electronics Equipment (RoHS).

Safety Instructions and Warnings

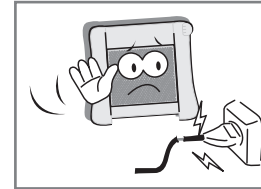

Do not use a damaged socket and do not let the power cord touch a heat source.
– This may cause an electric shock or fire.

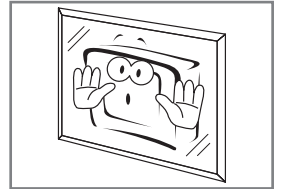

Do not add an additional screen or cover the TileVision's glass.
– The heated screen prevents condensation forming in steamy rooms and covering the screen may cause the unit to overheat.

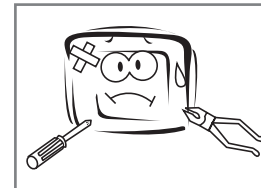

Do not attempt to service the unit.
Contact an authorised dealer or repair service.
– Servicing the unit yourself may cause an electric shock or fire.

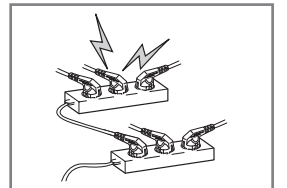

Do not connect too many extension cords or plugs to an outlet.
– This may cause a fire.

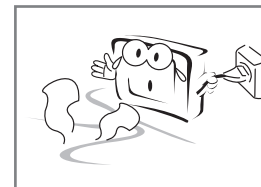

If there are any unusual sounds or smells coming from the unit, unplug it immediately and contact an authorised dealer or repair service.
– This may cause an electric shock or fire.

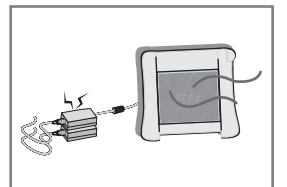

Keep the power adaptor away from any heat source.
– This may cause a fire.

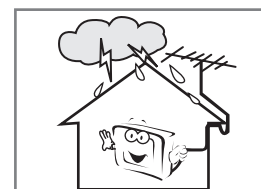

If an outside antenna is connected to the unit, ensure the external to internal cable entry is fully sealed
– This may cause an electric shock or fire.

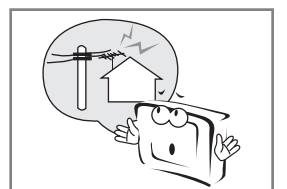

Ensure the antenna is located away from overhead cables.
– This may cause an electric shock.

To prevent injury, the TileVision® must be securely attached to the wall in accordance with the installation instructions.

The power supply must be connected to a mains socket outlet with a protective earth connection.

The mains plug or the pull switch is the disconnect device and must remain readily operable.

Failure to observe the above safety warnings may invalidate the warranty.

Tools Required

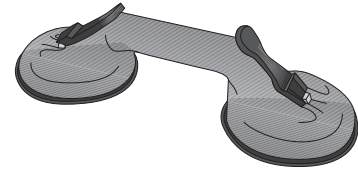

Suction Lifter

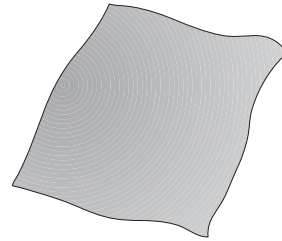

Soft Cloth

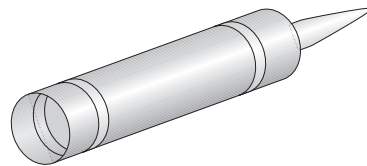

Clear Silicone Sealant



Isopropyl Alcohol

- Silicone Sealant produces acetic acid during cure. Use only in well ventilated areas. Irritating to eyes. Wash hands after use and before meals. Wash splashes from skin, clothing and other surfaces. Use a clean cloth. In case of contact with eyes wash immediately with plenty of water.**

Please observe safety precautions on the container. Keep out of reach of children and animals.



- Isopropyl alcohol is available from most pharmacies and larger electronics wholesalers. It is an effective degreasing agent.**

Please observe safety precautions on the container. Keep out of reach of children and animals. Do not drink.



Table of Contents

Safety Instructions and Warnings	1
Tools Required	2
Unpacking your TileVision®	4
Your TileVision®	4
TileVision® Connector Inputs	5
Connecting to your TileVision®	6
Connecting an Antenna or Cable	7
Sky™ Remote Control Link Setup	7
Connecting to the HDMI and S-VIDEO Inputs	8
Connecting to the SCART Input	9
Installing the Front Plate	10
The Waterproof Remote Control	12
The Full Function Remote Control	13
Switching the TileVision® On/Off	14
Selecting your On-screen Language	14
Selecting a Picture from External Sources	15
Displaying Information (TV Mode)	15
On-screen Menus and Displays (TV Mode)	16
Tuning, Setup and Editing Analogue TV Programmes – Auto Programme	17
Tuning, Setup and Editing Analogue TV Programmes – Manual Programme	18
Tuning, Setup and Editing Analogue TV Programmes – Edit, Delete, Select Programmes	19
Tuning, Setup and Editing Analogue TV Programmes – Moving and Skipping Programmes	20
Auto Tuning Digital TV	21
Digital TV Programme Information – General and Detailed Programme Information	22
Digital TV Setup – Banner Display Time	23
Digital TV Setup – Subtitle Language	24
Digital TV Setup – Audio Language	25
Digital TV Setup – Common Interface	25
Digital TV – Basic Operation – Signal Strength	26
Digital TV – Basic Operation – Software Update	27
Digital TV – Basic Operation – Selecting a Menu Language	28
Digital TV – Basic Operation – New Service Message, Active Antenna	29
Digital TV – Electronic Programme Guide (EPG) – Viewing the EPG	30
Digital TV – Electronic Programme Guide (EPG) – Edit Favourite Channel Groups	31
Picture Control – Manual Picture Control	33
Picture Control – Auto Picture Control, Picture Effect	34
Sound Control – Manual Sound Control	35
Sound Control – Auto Sound Control	36
Sound Output Selection – Mono Output Selection	36
Clock Functions	37
Other Functions – Noise Reduction, Blue Back, Auto Sleep and Sleep Timer	38
Child Lock	39
Aspect Ratio Control (ARC)	39
The Programme List	40
DTV Text	41
Analogue TV Teletext – Functions of Teletext	42
Displaying the Teletext Information	42
Teletext Button Functions	43
Troubleshooting	44
Specifications	45

Unpacking your TileVision®

☞ If any items are missing, contact your dealer.

Please make sure the following items are included with your TileVision®.

- 1 TileVision® glass front plate assembly – complete with Velcro fixing strips
- 1 waterproof remote control
- 1 remote control holder
- 1 standard full function remote control
- 1 installation and instruction manual
- 1 mirror acrylic surround.

Your TileVision®

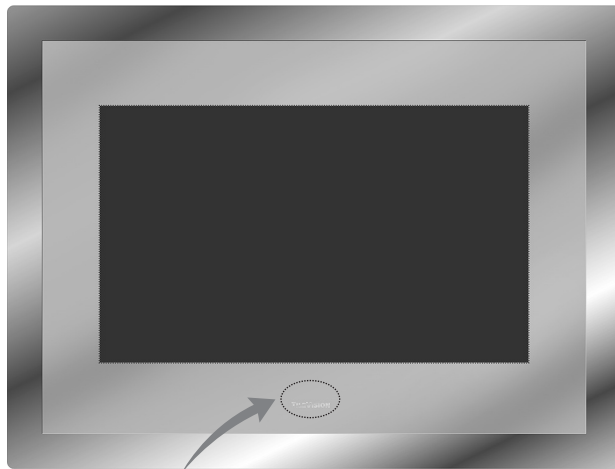

Remote control sensor and indicator

Power Indicator Status

Indicator	Status
Red	Stand-by
Green	Power on
Red blinking	Remote control

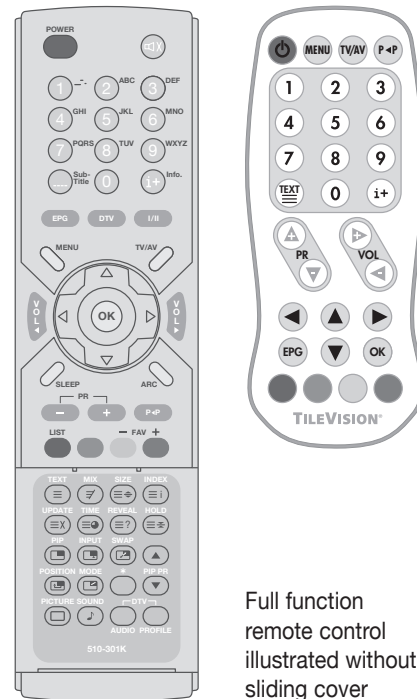

Full function remote control illustrated without sliding cover

TileVision® Connector Inputs

TV 17 Main Connector Array

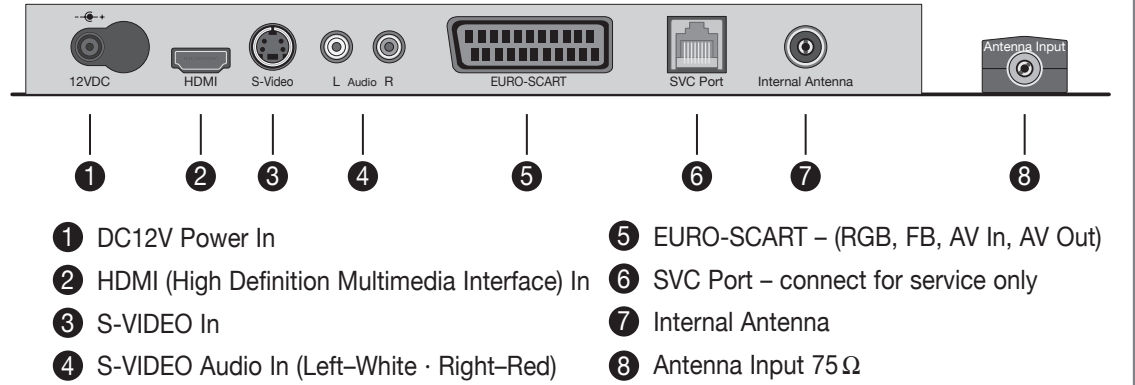

TV 23 Main Connector Array

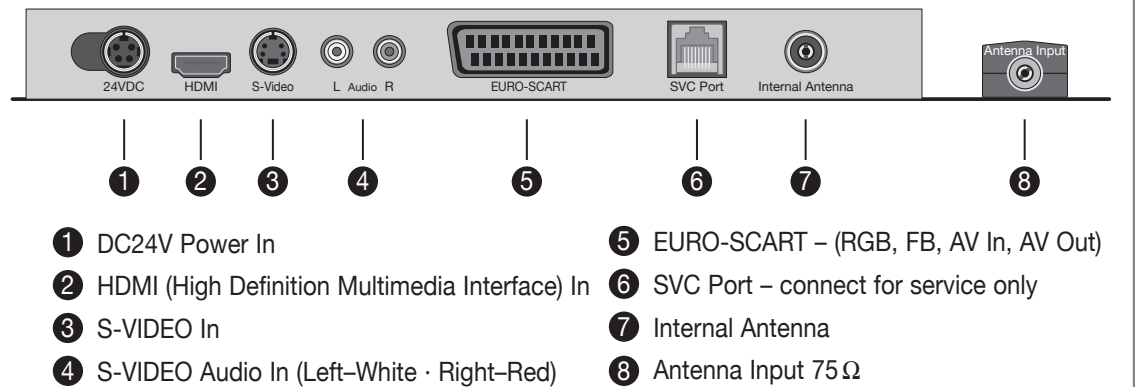

The antenna should be connected to the TileVision® using the Antenna Input (8) and not to the Internal Antenna connection (7). This allows a Sky™ or Sky+™ remote control to be used to change channel on the Sky™ digital receiver via the infrared sensor in the TileVision®. See page 7 for more information.

Connecting to your TileVision®

Earthing Points

The Earthing connection points are found on the rear of the front plate and are clearly marked with green labels. Connect the earthing cables from the back box to these points.

Power Socket

The Power socket (1) is located at the extreme left of the connection array.

Speaker Connections

The speakers should be connected after the Earth straps to the rear of the front plate as detailed on page 10 of these operating instructions.

The speaker connection block is found on the right of the rear of the front plate. Lift one of the lugs, push one conductor of the speaker lead into the connector, release the lug and give the lead a slight pull to make sure that it is gripped correctly. The other wires are connected in the same way.

Note: To ensure that the speakers are in correct phase, the conductor with the stripe should be connected to the negative terminal (L- or R-) and the plain conductor should be connected to the corresponding positive terminal (L+ or R+).

Connections to the speakers terminals should be made in the same way – striped conductor to the negative terminal and plain conductor to the positive terminal.

Antenna Feed

The Antenna input jack is found at the extreme right of the connection array (refer to page 7). A minimum signal level of 60dBu/1mV is required to avoid a noisy picture.

Additional connections

Connectors for; HDMI, SCART, S-VIDEO and Audio are found in the central portion of the connection array. If these inputs are to be utilised the necessary cables must be installed at the same time as the back box. COMPONENT video can also be connected via a suitable COMPONENT to SCART adaptor (refer to pages 8 and 9 of these instructions).

Note: Careful consideration should be given to use of these inputs prior to the installation of the unit.

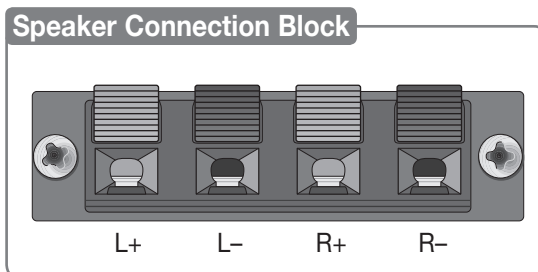

Connecting an Antenna or Cable

To view television channels correctly, a signal must be received by the set from one of the following sources: an outdoor antenna, a cable television system or a satellite dish.

- 1 Connect the antenna or input cable to the **75Ω coaxial input** on the rear of the TileVision®.
- 2 If you are using an indoor antenna in the loft space, you may need to turn it when tuning your television until you receive a clear picture.

☞ **The signal level fed to the set must be at least 60dBu/1mV or the picture may be noisy.**

If in doubt, consult a qualified aerial technician.

See page 29 for Active Antenna set-up.

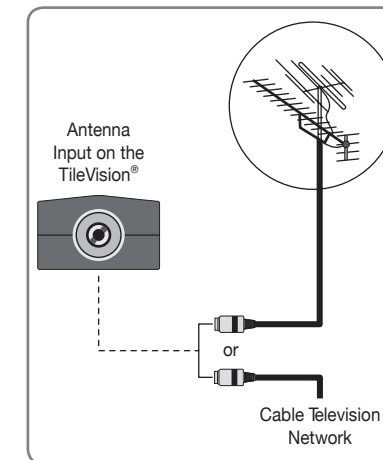

Sky™ Remote Control Link Setup

If a TileVision® is used with a Sky™ digital receiver which has two RF outputs, the channel can be changed on the Sky™ receiver using the Sky™ remote control via the remote sensor on the TileVision®.

The connection to the Antenna/RF sockets on the TileVision® and the Sky™ receiver must be made with both the TileVision® and the Sky™ receiver disconnected from the mains supply.

Once the connections have been made, the Sky™ receiver must be setup to supply power to the RF2 socket as detailed below.

- 1 On the Sky™ remote control press **SERVICES** to show the SERVICES menu.
- 2 Press the **4** button for the SYSTEM SETUP menu.
- 3 Press the **0** button, then the **1** button, then the **select** button, in sequence, to display the INSTALLER SETUP menu.
- 4 Press the **4** button to select RF OUTLETS.
- 5 Press the **down** arrow to select RF Outlet Power Supply and press the **left** or **right** arrows to change the setting to ON.
- 6 Press the **down** arrow to select Save New Settings and press **select** to save the settings.
- 7 Press the **sky** button to return to the previously viewed channel.

☞ **To set-up the Sky™ receiver to work with the TileVision® you must use the Sky™ remote control via the main TV (TV 1).**

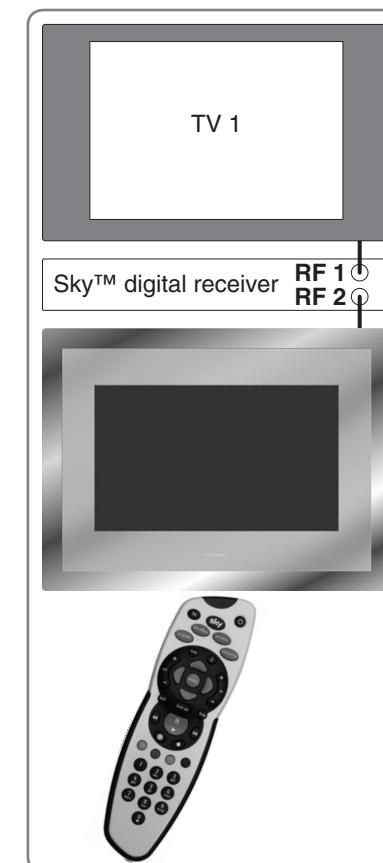

Connecting to HDMI and S-VIDEO Inputs

All connections must be made before sealing the front plate into the back box.

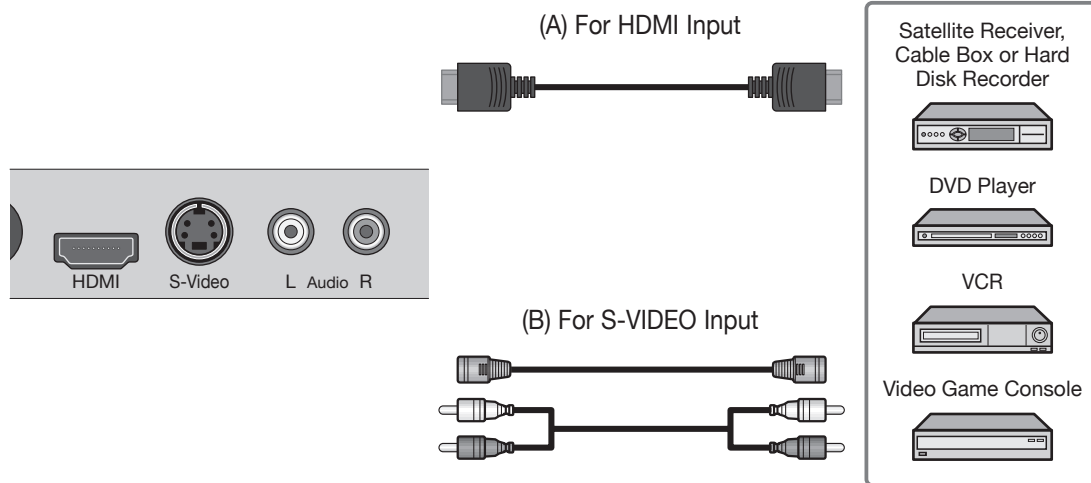

All connections must be made prior to sealing the front plate into the back box.

(A) For HDMI Input

- 1 Connect the HDMI cable to the HDMI input on the TileVision® and output on the external equipment such as satellite receiver or HD DVD player.

(B) For S-VIDEO Input

- 1 Connect the S-VIDEO/RCA and audio L/R cable to the inputs on the TileVision® and outputs on the external equipment such as a VCR, camcorder and some video game devices.
- 2 If the external equipment has mono audio output, connect it only to the left socket of the Audio Input/Output.

HDMI Input from PC

- 1 Connect the HDMI out of the PC to the HDMI input on the TileVision® using a HDMI cable.

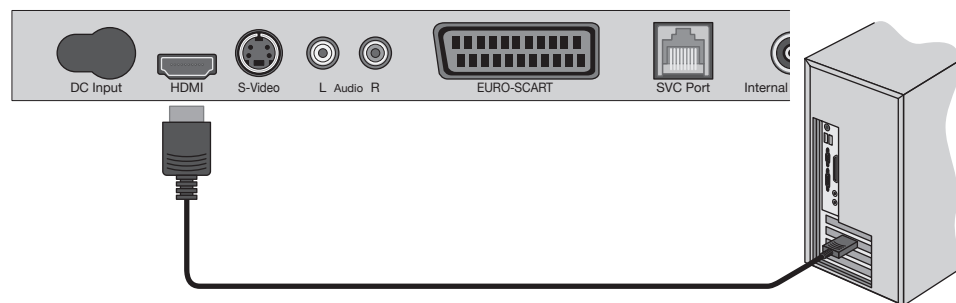

Connecting to the SCART Input

All connections must be made before sealing the front plate into the back box.

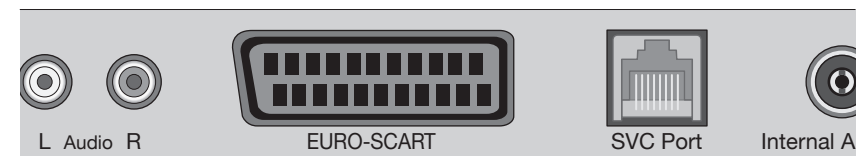

SCART Connection Reference

Pin	Name	Description
1	AOR	Audio Out Right
2	AIR	Audio In Right
3	AOL	Audio Out Left + Mono
4	AGND	Audio Ground
5	BGND	RGB Blue Ground
6	AIL	Audio In Left + Mono
7	B	RGB Blue
8	SWTCH	Audio, RGB switch, 16:9
9	GGND	RGB Green Ground
10	CLKOUT	Clock Out
11	G	RGB Green
12	DATA	Data Out
13	RGND	RGB Red Ground
14	DATAGND	Data Ground
15	R	RGB Red
16	BLNK	Blanking Signal
17	VGND	Composite Video Ground
18	BLNKGND	Blanking Signal Ground
19	VOUT	Composite Video Out
20	VIN	Composite Video In
21	SHIELD	Chassis Ground, Cable Shield

(A) SCART to SCART connector (RGB Video + Audio L/R or Composite Video + Audio L/R)



(B) SCART to RCA connectors (Composite Video + Audio L/R)



(C) SCART to RCA adaptor (Composite Video + Audio L/R)

(D) SCART to COMPONENT adaptor (Y, Pb, Pr)

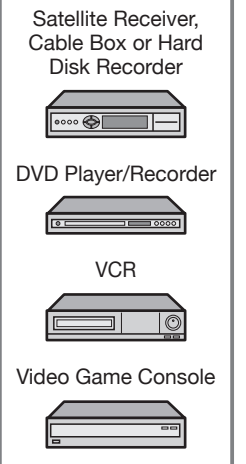

SCART Pinouts (solder side view)

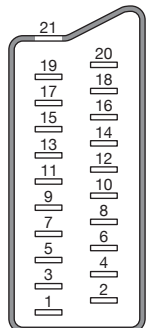

The EURO-SCART socket can be connected to equipment with RGB or composite video inputs and outputs. A VCR, satellite or cable receiver, DVD player, or video game console should be connected using the EURO-SCART connection.

- ◆ The EURO-SCART socket is fully connected as shown above.
- ◆ The audio output from the EURO-SCART can be connected to a separate amplifier to allow integration with a multi-room audio video system. This should be carried out by a qualified engineer.
- ◆ Adaptors are commercially available to allow video and audio equipment to be connected to the TileVision® via the EURO-SCART socket. See the examples in diagrams B (SCART to RCA), C (SCART to RCA) and D (SCART to COMPONENT).
- ◆ When connecting COMPONENT video via the SCART socket, connections must be made to the chosen COMPONENT to SCART adaptor and Audio L and R. Select the COMPONENT input from the Input Selection Menu (see page 15).

Installing the Front Plate

Note: A glass carrier/suction lifter is required.

Checking back box prior to installation of front plate

Before commencing the installation of the front plate the polystyrene blanking panel must be removed from the back box. The next step is to ensure that the appropriate cables and their connectors are present within the back box.

It is important to ensure that the flange inside the back box is cleaned using a grease removal agent and allowed to dry. The space between the back box and front plate must be even on all four sides. If the flange needs to be straightened, this must be done before proceeding any further. This is very important, as any damage will affect the unit's waterproofing capabilities.

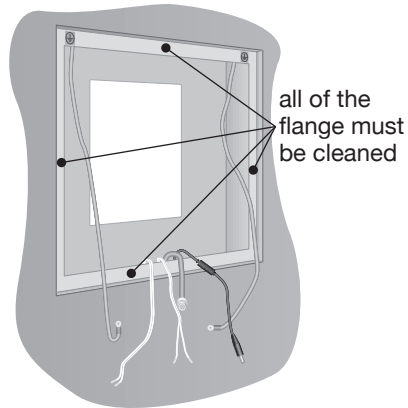

Installation of the front plate

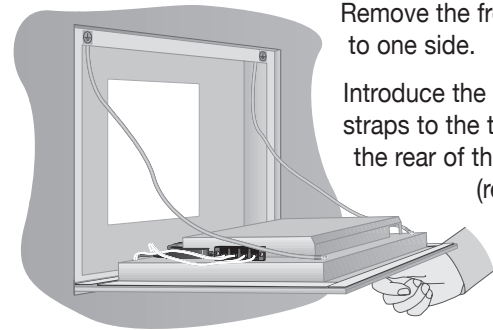

Remove the front plate from its packaging and place the remote control to one side.

Introduce the lower front edge of the unit into the box and fit the earth straps to the two Earthing screws as indicated by the green labels on the rear of the front plate. Connect all cables to their respective sockets (refer to pages 5 to 9 of these instructions).

The next step is to remove the soft adhesive protector from the top length of special Velcro, and press the front plate into the back plate (it may be necessary to adjust the position of the cables to achieve a good fit).

The unit installation must comply with all relevant electrical safety regulations before turning the mains supply to the 12VDC power adaptor on using the remote pull switch. The unit should now show a red indicator light showing that it is in standby mode.

The next step is to tune the unit as detailed on pages 17 to 20 and 22.

Once you are satisfied that the unit is tuned and working correctly, press the Power 0/I button on the remote control to put the unit in standby mode and isolate the unit using the remote pull switch.

Gently remove the front plate using a suction lifter. Do not use a lever to remove the front plate as this will invalidate your guarantee. Next, remove the self-adhesive protectors from the side and bottom Velcro strips and press the front panel into the back box with reasonable force. Take care to apply force to all four sides of the box. Restore mains power using the remote pull switch and press the Power 0/I button on the remote control to turn the unit on again and check that it is still working correctly.

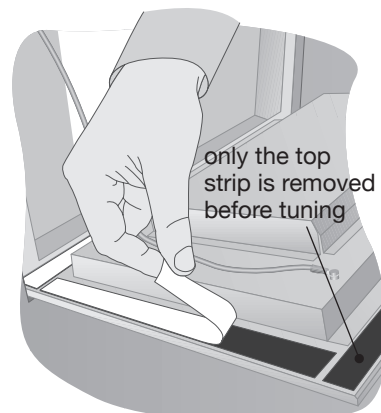

Sealing the unit

When you are sure that the unit is installed correctly put it in standby mode and apply a clear silicone sealant to the joint between the sides of the back box and the sides of the front plate. Ensure that the

Installing the Front Plate

fill all the space between the edge of the screen and the back box

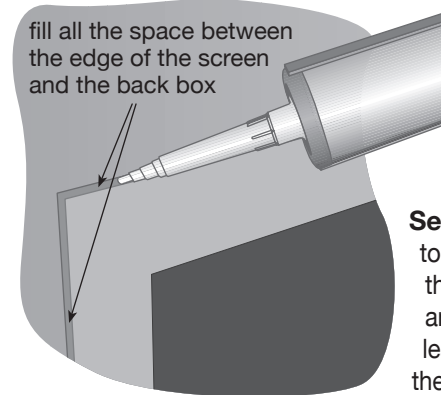

silicone is worked into the space evenly and is applied without any gaps, bubbles or voids. Wipe any excess silicone sealant away and check for any imperfections. Rectify any errors as necessary. **This seal is essential for the reliable and safe operation of the TileVision® and must be completely waterproof.**

Sealing Tip: To achieve a neat seal easily it may be found useful to use masking tape around the TileVision® glass screen and the surrounding tiles, just leaving sufficient gap to apply the silicone sealant around the joint between the sides of the back

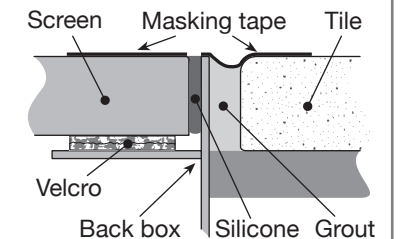

box and front plate. The acrylic surround can be fitted using silicone sealant once the tape is removed.

Fitting the acrylic surround

The mirrored acrylic surround is a cosmetic addition and has no bearing on the integrity of the waterproof seal of the TileVision®.

If the surround is being fitted to the TileVision®, the same silicone sealant used to seal the screen into the back box can be used to fasten the surround to the wall.

Lay the surround on a flat surface and apply the silicone to the matt grey surface as shown. Once the adhesive has been applied, align the surround with the TileVision® using a spirit level as a guide and press the acrylic surround firmly to the wall.

After the silicone sealant has hardened the protective film can be removed from the front of the surround.

Cleaning Instructions

To clean the screen and surround, use only a soft damp cloth. Under no circumstances are abrasive cleaners to be used, failure to observe this warning will invalidate your guarantee.

Note: It is the installer's responsibility to ensure that the TileVision® unit is installed and sealed correctly, failure to do so will invalidate your guarantee. The unit will require cleaning and re-sealing after any servicing/repair operation.

The Waterproof Remote Control

Buttons marked (D) are only available in Digital TV mode.



Make sure there are no objects between the remote control and its sensor.

Do not place the remote control near a heater.

A strong blow to the remote control may cause it not to operate.

- 1 **Power On/Off button** – Turns the TileVision® on from, or off to, standby
- 2 **Menu button** – Displays the main menu
- 3 **TV/AV button** – Selects between DTV, TV, SCART, COMPONENT, S-VIDEO or HDMI mode. Clears the menu from the screen
- 4 **Previous Programme button** – Returns to the previously viewed programme
- 5 **Number buttons** – Selects programme numbers
- 6 **Teletext On/Off button** – See page 42 for Teletext function table (buttons 16 to 19)
- 7 **Info button (D)** – Displays the information about the channel and programme when in the Digital TV mode
- 8 **PR (Programme up/down) buttons** – Selects next or previous programme
- 9 **VOL (Volume up/down) buttons** – Adjust the volume
- 10 **Menu left button** – Menu and EPG navigation
- 11 **Menu up button** – Menu and EPG navigation
- 12 **Menu right button** – Menu and EPG navigation
- 13 **EPG button (D)** – Displays the Electronic Programme Guide
- 14 **Menu down button** – Menu and EPG navigation
- 15 **OK button** – Accepts your selection or displays current mode
- 16 **Colour buttons** – Teletext FastText & Digital TV menu options

The Full Function Remote Control

Buttons marked (D) are only available in Digital TV mode.

- 1 **Power On/Off button** – Turns the TileVision® on from, or off to, standby
- 2 **Mute button** – Turns the sound on or off
- 3 **Number buttons** – Selects programme numbers
- 4 **Subtitle button (D)** – Changes language
- 5 **Info. button (D)** – Displays the information about the channel and programme
- 6 **EPG button (D)** – Displays the Electronic Programme Guide
- 7 **DTV button** – Switches between analogue and digital TV
- 8 **I/II button** – Selects language for dual language broadcasts
- 9 **Menu button** – Displays the Main Menu
- 10 **TV/AV button** – Selects between DTV, TV, SCART, COMPONENT, S-VIDEO or HDMI mode. Clears the menu from the screen
- 11 **Menu left/right buttons** – Menu and EPG navigation
- 12 **Menu up/down buttons** – Menu and EPG navigation
- 13 **OK button** – Accepts your selection or displays current mode
- 14 **VOL (Volume up/down) buttons** – Adjust the volume
- 15 **Sleep button** – Sets the sleep timer
- 16 **ARC (Aspect Ratio Control) button** – Change picture format: Auto, 16:9, 14:9, 4:3, 16:9 zoom, 14:9 zoom, 4:3 zoom
- 17 **PR (Programme up/down) buttons** – Selects next or previous programme
- 18 **Previous Programme button** – Returns to the previously viewed programme
- 19 **Colour buttons** – Teletext FastText & Digital TV menu options
- 20 **LIST button** – Display the programme list
- 21 **FAV +/-** – Press to switch to your favourite channels
- 22 **Teletext buttons** – See page 43 for Teletext function table
- 23 **PIP buttons** – Picture in Picture is not available on TileVision
- 24 **Picture button** – Press to recall your preferred picture settings
- 25 **Sound button** – Press to recall your preferred sound settings
- 26 **AUDIO button (D)** – Select audio language directly
- 27 **PROFILE button (D)** – Select User Profile directly

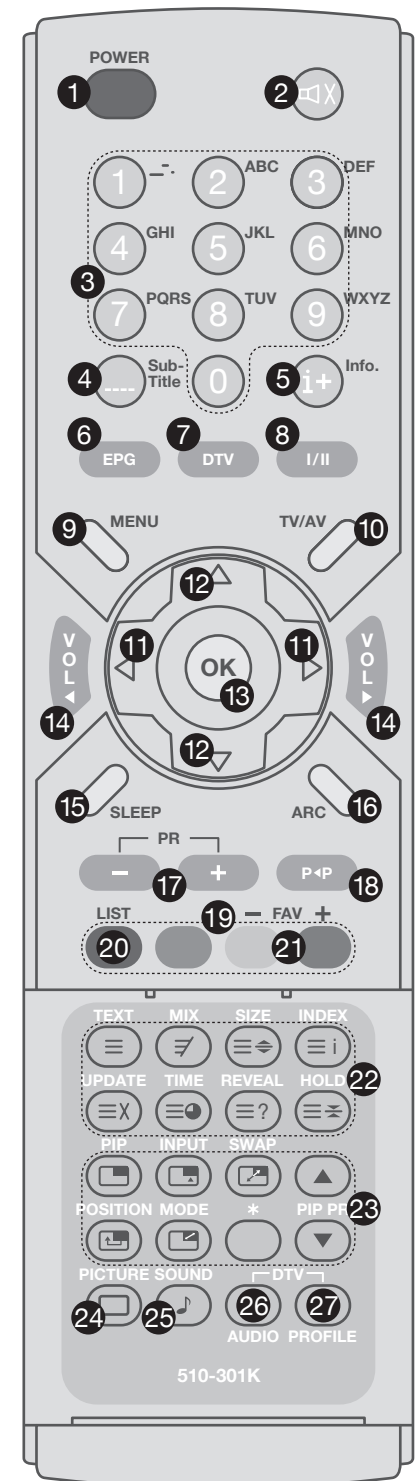

Switching the TileVision® On/Off

Please allow a minimum of five seconds after switching the TileVision® off before switching it on again.

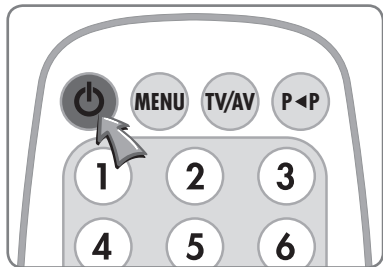

- 1 To switch your TileVision® on, press the **POWER** (⏻) button.
- 2 To switch your TileVision® to standby, press the **POWER** (⏻) button again.

Selecting your On-screen Language

When you start using your TV for the first time, select the language in which to display all on-screen menus.

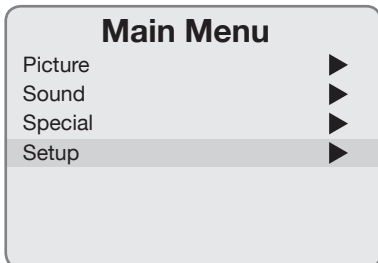
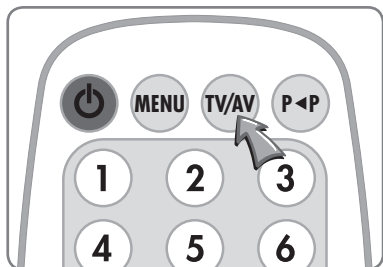

- 1 Press the **TV/AV** (TV/AV) button to display the Input Selection menu. Press **TV/AV** (TV/AV) repeatedly until **TV** mode is selected. After a short delay the desired input will be selected and the menu will be cleared from the screen.
- 2 Press the **MENU** (MENU) button to display the Main Menu.
- 3 Press the **▲▼** buttons to select the **Setup** menu and then press the **▶** button.
- 4 Press the **▲▼** buttons to select the **Language** menu and then press the **▶** button.
- 5 Press the **▲▼**, **◀▶** buttons to select your desired language.
- 6 Press **TV/AV** (TV/AV) to exit the menus and confirm settings.

All the on-screen displays will now appear in the selected language.

The language selected applies to both TV and DTV modes

Selecting a Picture from External Sources

If external sources have been connected to your TileVision®, you can view any of the sources by selecting the appropriate external input.

- 1 Make sure all the necessary connections have been made.
- 2 Press the **POWER** (⏻) button to switch the device on.
- 3 Press the **TV/AV** (TV/AV) button to select the required external input: SCART, COMPONENT, S-VIDEO or HDMI.
- 4 After a short delay the desired input will be selected and the menu will be cleared from the screen.

A COMPONENT to SCART adaptor must be used to enable COMPONENT video connection (see page 9).

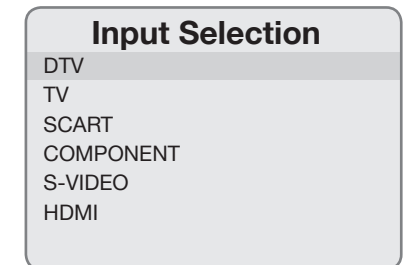
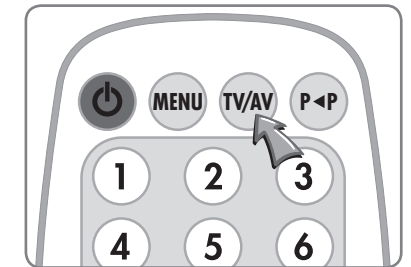

Displaying Information (TV Mode)

You can display the programme information and settings status currently in use.

- 1 Press the **OK** (OK) button.

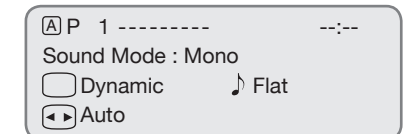

On-screen Menus and Displays (TV Mode)

- 1 Press the **MENU** (MENU) button to display the Main menu.
- 2 Press the **▲▼** buttons to select menus.
- 3 Press **◀▶** buttons to adjust menu items.
- 4 Press **MENU** (MENU) to go back to the previous menu.
- 5 Press **TV/AV** (TV/AV) to exit the menus and confirm settings.

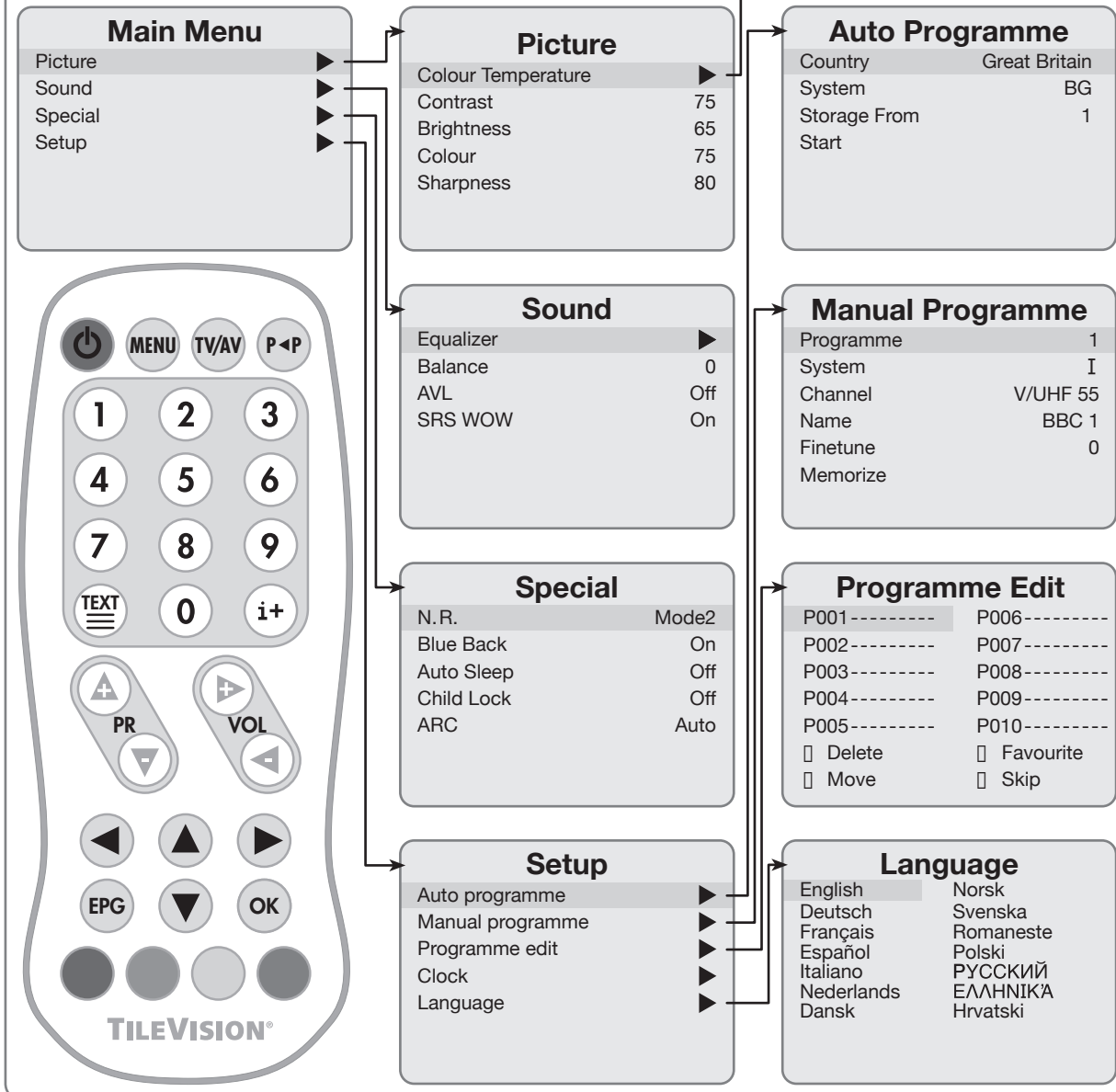

Tuning, Setup and Editing Analogue TV Programmes

Note: It is recommended that Auto Programme is used when installing TileVision® as all available programmes will be stored.

Auto Programme

- 1 Press the **MENU** (MENU) button.
- 2 Press the **▲▼** buttons to select the **Setup** menu and then press the **▶** button.
- 3 Press the **▲▼** buttons to select the **Auto Programme** menu and then press the **▶** button.
- 4 Select the Country with the **◀▶** buttons. Choose from: Austria, Belgium, Switzerland, Czech Rep, Germany, Denmark, Spain, France, Finland, Great Britain, Greece, Hungary, Italy, Norway, Netherlands, Portugal, Poland, Sweden, Slovenia, Slovakia, Turkey, others.
- 5 Press the **▲▼** buttons to select the **System**.
- 6 Select a TV system with the **◀▶** buttons:
 - BG:** Western Europe/Asia/Middle East/Africa/Australia
 - I:** UK/Hong Kong/South Africa
 - DK:** Russia/China/Eastern Europe
 - L:** France.
- 7 Press **▲▼** buttons to select Storage From.
- 8 Select the beginning programme number with the **◀▶** buttons or **NUMBER** buttons.
- 9 Press the **▲▼** buttons to select **Start** and press the **▶** button to confirm. The Auto Programme will now start, this will take a few minutes to complete.

To delete, skip, move or name the stored programmes see **Programme Edit**, on page 19.

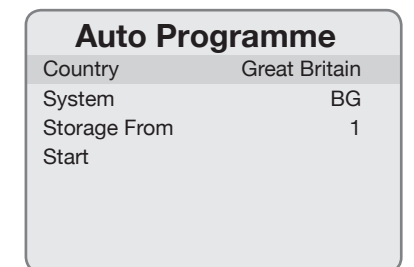
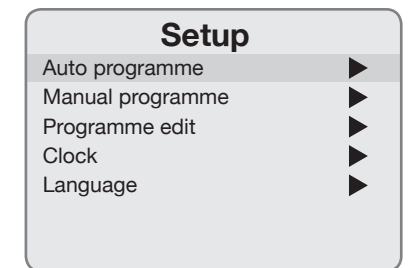
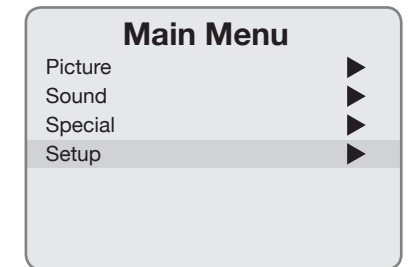
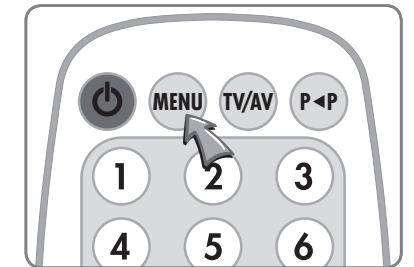

Tuning, Setup and Editing Analogue TV Programmes

Manual Programme lets you tune and arrange the programmes in any order you want. You can assign an eight character programme name to each programme number.

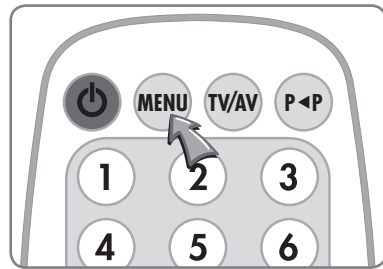

Main Menu

Picture ▶▶
Sound ▶▶▶
Special ▶▶▶
Setup ▶▶▶

Setup

Auto programme ▶▶
Manual programme ▶▶▶
Programme edit ▶▶▶
Clock ▶▶▶
Language ▶▶▶

Manual Programme

Programme	1
System	I
Channel	V/UHF 55
Name	BBC 1
Finetune	0
Memorize	

Manual Programme

- 1 Press the **MENU** (MENU) button.
- 2 Press the ▲▼ buttons to select the **Setup** menu and then press the ▶ button.
- 3 Press the ▲▼ buttons to select the **Manual Programme** menu and then press the ▶ button.
- 4 Select the programme with the ◀▶ buttons or number buttons.
- 5 Press the ▲▼ buttons to select the **System**.
- 6 Select a TV system with the ◀▶ buttons:
BG: Western Europe/Asia/Middle East/Africa/Australia
I: UK/Hong Kong/South Africa
DK: Russia/China/Eastern Europe
L: France
- 7 Press ▲▼ buttons to select **Channel**. Then, press the ▶ button to select V/UHF or Cable.
- 8 Press the ▲▼ buttons to select **V/UHF** or **Cable** as required and press the ▶ button to confirm. Select the channel number either directly with the number buttons or the ▲▼ buttons. Press the ▶ button to confirm.
- 9 You can assign a programme name with up to eight characters using the numbers 0–9, the alphabet from A–Z, and a space.
Press ▲▼ buttons to select **Name**. Then press the ▶ button.
Press the ◀▶ buttons to move the red cursors to select the character to edit. Press the ▲▼ buttons to select the desired letter or number. Press the ▶ button to select the next character to edit or confirm the name when on the last letter.
- 10 Press ▲▼ buttons to select **Finetune**.
Press the ◀▶ buttons to adjust the fine tuning.
- 11 Press ▲▼ buttons to select memorize.
- 12 Press the ▶ button or **OK** (OK) button to store it.
- 13 Press the **Menu** button to return to the previous menu.
- 14 Press the **TV/AV** (TV/AV) button to return to normal TV viewing.

Tuning, Setup and Editing Analogue TV Programmes

Programme Edit

This function enables you to delete, make favourite, move or skip the stored programmes.

You can also move channels to different programme numbers, or insert blank programme data into the selected programme number.

- 1 Press the **MENU** (MENU) button.
- 2 Press the ▲▼ buttons to select the **Setup** menu and then press the ▶ button.
- 3 Press the ▲▼ buttons to select **Programme Edit** and then press the ▶ button.
- 4 Select the programme name to edit with the ▲▼ buttons and ◀▶ buttons.

Deleting a programme

- 1 Select a programme to be deleted with the ▲▼ or ◀▶ buttons.
- 2 Press the **RED** button once. The selected programme is deleted, all the following programmes shift up one position.

Selecting a favourite programme

- 1 Select a favourite programme with the ▲▼ buttons or ◀▶.

- 2 Press the **GREEN** button.

This function lets you select your favourite programme directly.

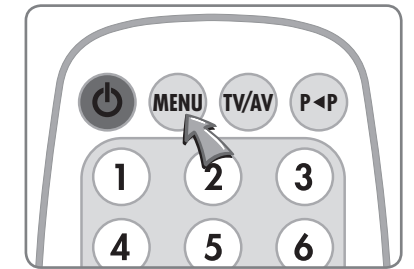

Main Menu

Picture ▶▶
Sound ▶▶▶
Special ▶▶▶
Setup ▶▶▶

Setup

Auto programme ▶▶
Manual programme ▶▶▶
Programme edit ▶▶▶
Clock ▶▶▶
Language ▶▶▶

Programme Edit

P001-----	P006-----
P002-----	P007-----
P003-----	P008-----
P004-----	P009-----
P005-----	P010-----
<input type="checkbox"/> Delete	<input type="checkbox"/> Favourite
<input type="checkbox"/> Move	<input type="checkbox"/> Skip

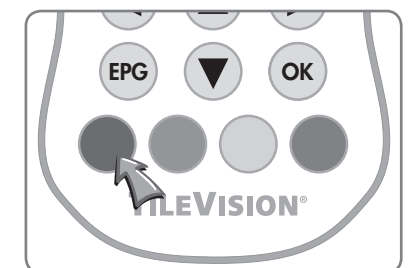

Tuning, Setup and Editing Analogue TV Programmes

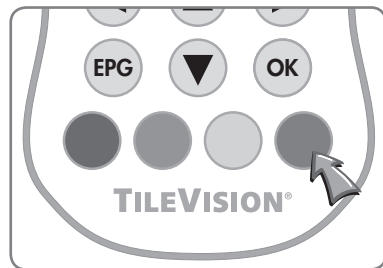
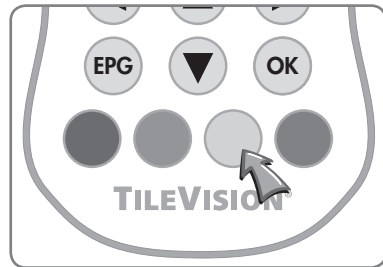

Moving a programme in Programme Edit menu

- 1 Select a programme to be moved with the ▲▼ or ◀▶ buttons.
- 2 Press the **YELLOW** button.
- 3 Move the programme to the desired programme number with the ▲▼ or ◀▶ buttons.
- 4 Press the **YELLOW** button again to release this function.

Skipping a programme number in Programme Edit menu

- 1 Select a programme to be skipped with the ▲▼ or ◀▶ buttons.
- 2 Press the **BLUE** button. The skipped programme turns blue.
- 3 Press the **BLUE** button again to release the skipped programme.

☛ **When a programme number is skipped it means that you will be unable to select it using the PR ▲▼ buttons during normal TV viewing.**

If you want to select the skipped programme, enter the programme number with the NUMBER buttons, or select it in the programme edit menu.

Auto Tuning Digital TV

The TileVision® must be in DTV mode to perform Digital TV tuning. Press the **TV/AV** button and select DTV from the Input Selection menu.

Auto Tune all Receivable Digital Channels

- 1 Press the **MENU** (MENU) button to display **Main Menu** in the **DTV mode**.
- 2 On the **Main Menu**, use the ▲▼ buttons to select **DTV System**.
- 3 Press ▶ button to enter **DTV System** menu.
- 4 On the **DTV System** menu, press the ▲▼ buttons to select **DTV Scanning**.
- 5 Press the ▶ button to start DTV scanning.

The DTV Scanning menu is displayed and the DTV Scanning starts immediately.

Scanning, tuning and sorting can take several minutes – please wait for the TileVision® to finish the process.

Once the channel search has finished and all available channels have been stored, the channels will be sorted and channel 1 will be selected.

DTV Scanning			
Please wait!		0	100%
Pos.	Channel	ServiceName	Quality
31	56	BBC NEWS 24	Excellent
32	56	BBCI	Excellent
33	56	CBBC Channel	Excellent
34	56	BBC TWO	Excellent
35	56	BBC ONE	Excellent

◀▶ Back :MENU Exit :TV/AV

- ☛ **If you exit DTV Scanning without fully completing the channel searching procedure, the TileVision® may not have stored any digital TV channels.**

With the New Service Message set to On, a banner will be displayed when any new channels are added.

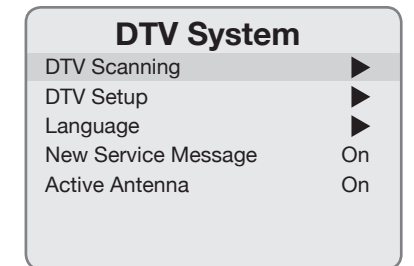
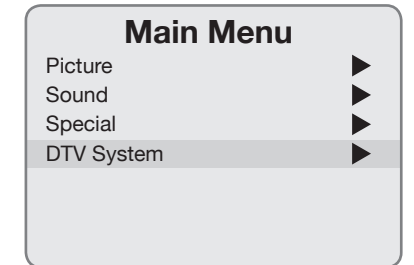
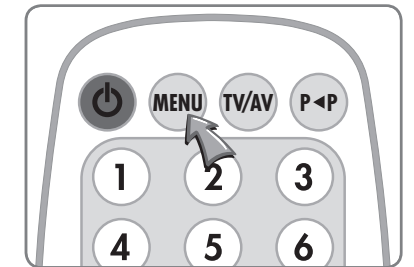

Digital TV Programme Information

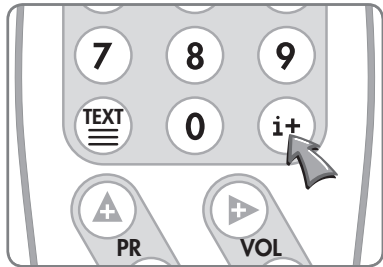
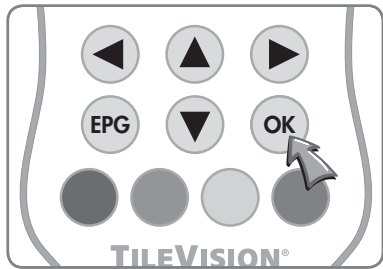

If no programme information is available no banner is displayed when the INFO (i+) button is pressed.

General Programme Information

The programme information banner is always displayed at the bottom of the screen for a preset period of time whenever you switch channels.

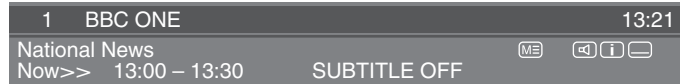

You can view the programme information at any time by pressing the OK (OK) button while watching a programme. The banner will be cleared from the screen after the preset time.

Detailed Programme Information

You can see more detailed information about the current programme at any time by pressing the INFO (i+) button.

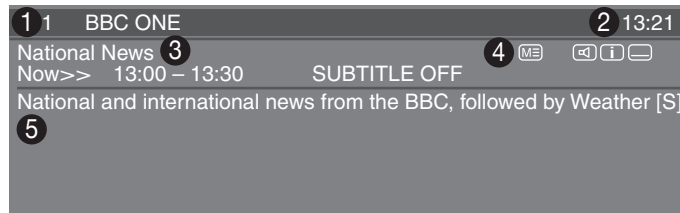

Press the INFO (i+) button again to remove the banner from the screen.

The layout of information contained in the banner is as shown below:

- 1 Channel number and channel name.
- 2 Current time.
- 3 Programme name.
- 4 Icons:
 - 🔒 Displayed only when the channel is a locked channel.
 - 📺 Displayed when the MHEG application is triggered to make DTV Text available. This icon will only be displayed in the United Kingdom, Ireland and New Zealand.
 - 🔊 Displayed only when the audio language is operated.
 - 📺 Displayed only when programme information is available.
 - 📄 Displayed only when subtitle text is available.
 - ☰ Displayed only when teletext is available.
- 5 Detailed programme information.

Digital TV Setup

Banner Display Time

You can choose a banner display time of 3, 5 or 10 seconds.

- 1 Press the MENU (MENU) button to display the Main Menu.
- 2 On the Main Menu, use the ▲▼ buttons to select DTV System.
- 3 Press the ► button to enter DTV System menu.
- 4 Use the ▲▼ buttons to select DTV Setup.
- 5 Use the ► button to enter DTV Setup.



- 6 Use the ◀▶ buttons to select the required banner display time.



- 7 Press the OK (OK) button to store the chosen display time and press the TV/AV (TV/AV) button to return to normal TV viewing.

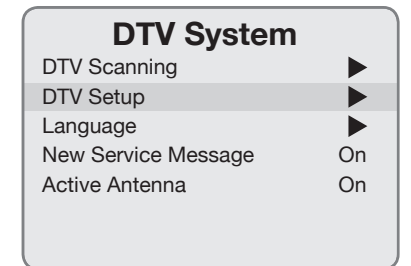
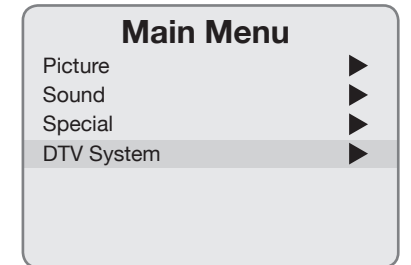
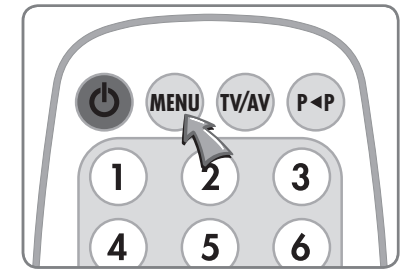

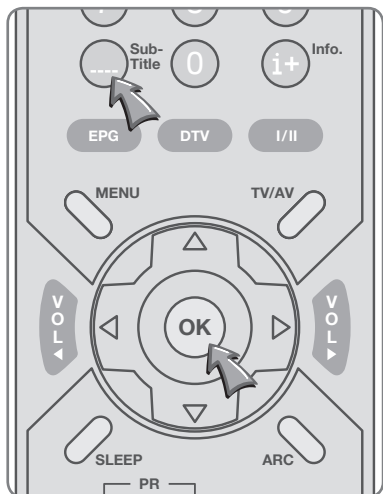
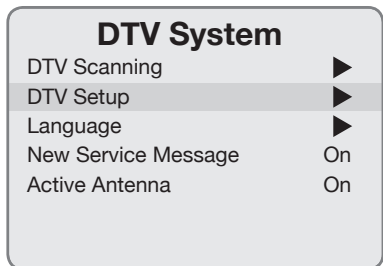
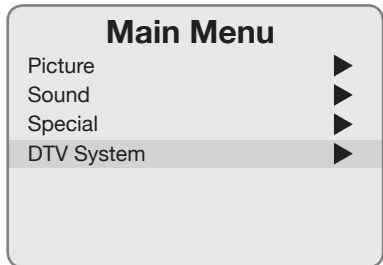
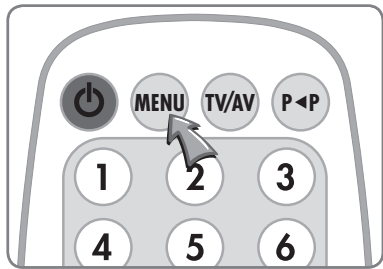

Subtitle Language

If the current programme provides subtitle information, you can select the language for the Subtitle.

- 1 Press the **MENU** (MENU) button to display the **Main Menu**.
- 2 On the **Main Menu**, Use the ▲▼ buttons to select **DTV System**.
- 3 Press the ► button to enter the **DTV System** menu.
- 4 On the **DTV System** menu, press the ▲▼ buttons to select **DTV Setup** and press the ► button to enter the **DTV Setup** menu.



- 5 Press the ▲▼ buttons to select **Subtitle Language** and use the ◀▶ buttons to select your desired subtitle language.
- 6 Press the **OK** (OK) button to save your selection as the language that subtitles will be displayed in at the bottom of the screen when Subtitles are switched on. Press the **TV/AV** (TV/AV) button to return to normal TV viewing.

Subtitles can only be switched on or off with the full function remote control.

Press the **Subtitle** button to display the Subtitle Option – press the **OK** button to confirm the option shown or press the **Subtitle** button to hide the Subtitle Option again.

☛ **Subtitles are not available from all broadcasters.**

All languages listed are not necessarily available from all broadcasters.

Audio Language

If the current programme is available in multiple audio languages, you can select the language that you wish to listen to.

- 1 Press the **MENU** (MENU) button to display the **Main Menu**.
- 2 On the **Main Menu**, Use the ▲▼ buttons to select **DTV System**.
- 3 Press the ► button to enter the **DTV System** menu.
- 4 On the **DTV System** menu, press the ▲▼ buttons to select **DTV Setup** and press the ► button to enter the **DTV Setup** menu.

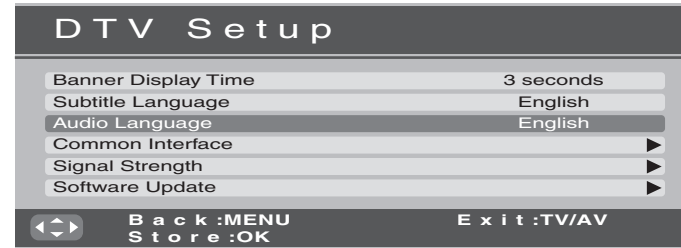

- 5 Press the ▲▼ buttons to select **Audio Language** and use the ◀▶ buttons to select your desired subtitle language.
- 6 Press the **OK** (OK) button to save your selection as the language for the broadcast. Press the **TV/AV** (TV/AV) button to return to normal TV viewing.

Common Interface

Common Interface is not applicable to TileVision®.

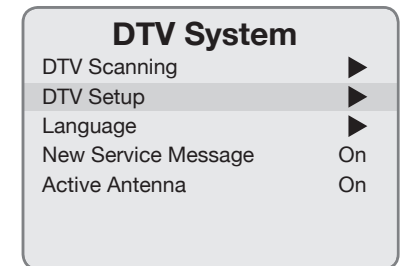
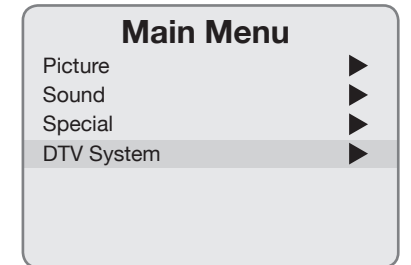
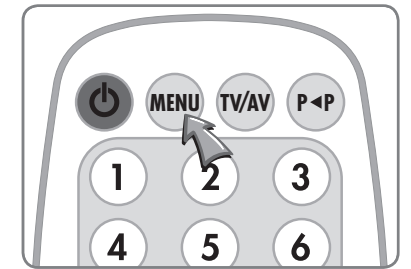

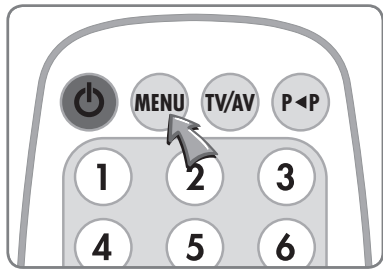

Main Menu

- Picture ▶▶▶
- Sound ▶▶▶
- Special ▶▶▶
- DTV System ▶▶▶

DTV System

- DTV Scanning ▶▶▶
- DTV Setup ▶▶▶
- Language ▶▶▶
- New Service Message On
- Active Antenna On

Signal Strength

You can check and see how strong the signal is for any stored channel.

- 1 Press the **MENU** (MENU) button to display the **Main Menu**.
- 2 On the **Main Menu**, Use the ▲▼ buttons to select **DTV System**.
- 3 Press the ▶ button to enter the **DTV System** menu.
- 4 On the **DTV System** menu, press the ▲▼ buttons to select **DTV Setup** and press the ▶ button to enter the **DTV Setup** menu.



- 5 Press the ▲▼ buttons to select **Signal Strength** and use the ▶ button to view the **Signal Strength** banner.



- 6 You can view the signal strength reception for the channel that is currently being viewed.
- 7 Press the **TV/AV** (TV/AV) button to return to normal TV viewing.

Software Update

To keep your TileVision® up-to-date with new digital television features, software updates are periodically broadcast as part of the normal television signal. Your TileVision® will automatically detect these signals and display the software update banner.



- 1 Press the **MENU** (MENU) button to display the **Main Menu**.
- 2 On the **Main Menu**, Use the ▲▼ buttons to select **DTV System**.
- 3 Press the ▶ button to enter the **DTV System** menu.
- 4 On the **DTV System** menu, press the ▲▼ buttons to select **DTV Setup** and press the ▶ button to enter the **DTV Setup** menu.



- 5 Press the ▲▼ buttons to select **Software Update** menu and press the ▶ button to enter **Software Update** menu.



- 6 Press the **OK** (OK) button to download the Software Upgrade.
- 7 After downloading is completed, wait for a moment. Then restart the TileVision® to install the software upgrade.

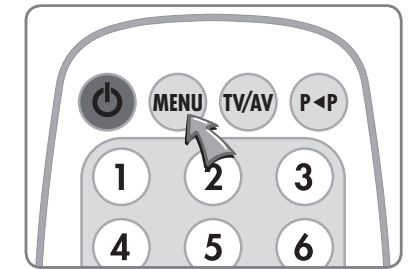
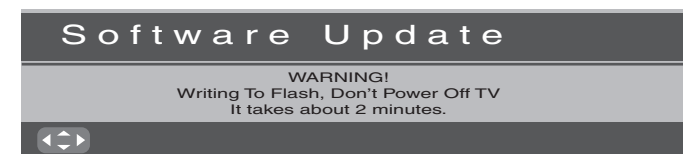

Main Menu

- Picture ▶▶▶
- Sound ▶▶▶
- Special ▶▶▶
- DTV System ▶▶▶

DTV System

- DTV Scanning ▶▶▶
- DTV Setup ▶▶▶
- Language ▶▶▶
- New Service Message On
- Active Antenna On

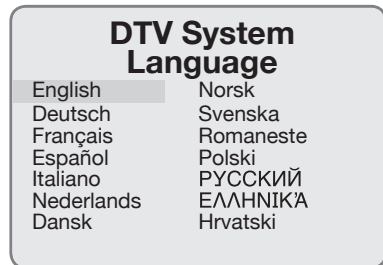
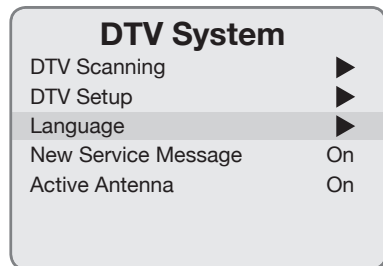
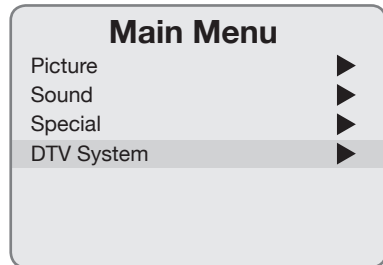
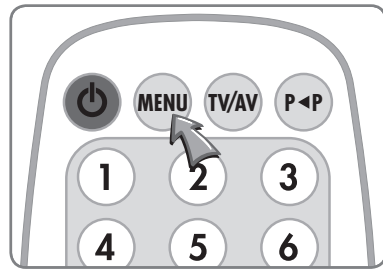

Selecting a Menu Language

The menu can be displayed on the screen in a desired language.

- 1 Press the **MENU** (MENU) button to display the **Main Menu**.
- 2 On the **Main Menu**, Use the ▲▼ buttons to select **DTV System**.
- 3 Press the ► button to enter the **DTV System** menu.
- 4 On the **DTV System** menu, press the ▲▼ buttons to select **Language**, and press the ► button to display the **Language** menu.
- 5 Press the ▲▼ or ◀▶ buttons to select the desired language.
- 6 Press the **TV/AV** (TV/AV) button to return to normal TV viewing.

👉 The language selected applies to both DTV and TV modes

New Service Message

If New Service Message is set to On, a banner will be displayed when any new channels are added.

- 1 Press the **MENU** (MENU) button to display the **Main Menu**.
- 2 On the **Main Menu**, Use the ▲▼ buttons to select **DTV System**.
- 3 Press the ► button to enter the **DTV System** menu.
- 4 On the **DTV System** menu, press the ▲▼ buttons to select **New Service Message**, and press the ◀▶ buttons to select On or Off.
- 5 Press the **TV/AV** (TV/AV) button to return to normal TV viewing.

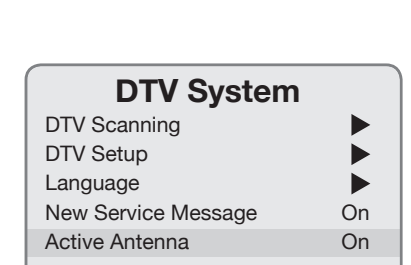
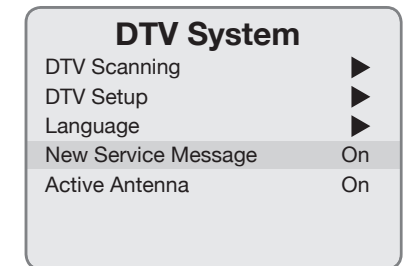
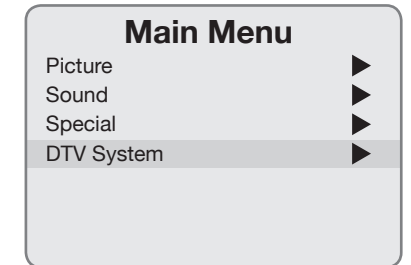
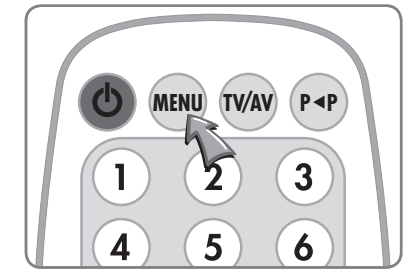

Active Antenna

If Active Antenna is set to On, the antenna receives 5V from the TileVision®.

If your antenna is external or a self-powered indoor antenna, set Active Antenna to Off, if not, set Active Antenna to On.

- 1 Press the **MENU** (MENU) button to display the **Main Menu**.
- 2 On the **Main Menu**, Use the ▲▼ buttons to select **DTV System**.
- 3 Press the ► button to enter the **DTV System** menu.
- 4 On the **DTV System** menu, press the ▲▼ buttons to select **Active Antenna**, and press the ◀▶ buttons to select On or Off.
- 5 Press the **TV/AV** (TV/AV) button to return to normal TV viewing.

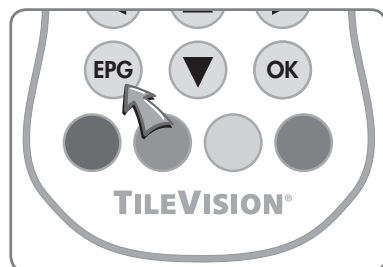

Viewing the EPG

The EPG information is provided by the broadcasters.

Programme entries may appear blank or out of date as a result of the information broadcast on a given channel. The display will dynamically update as soon as new information becomes available.

You can display EPG information at any time while watching digital programmes.

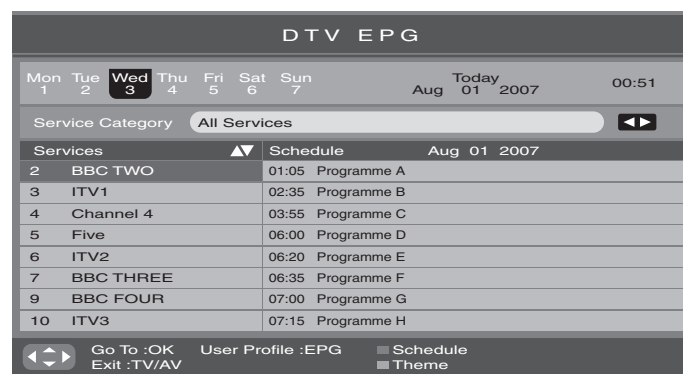

- 1 Press **EPG** (EPG) button to display the **DTV EPG** menu.
- 2 Use the numerical buttons to select the date for which you want to see the listing.
- 3 Press the **Blue** button to switch between **Service Category** and **Theme**.
- 4 Use the **Left/Right** buttons to select **Service Categories** or **Themes** of various kinds.
Service Category: All Service, Free to Air Services, Pay TV Services, Audio Services.
Themes: Movies, News, Entertainment, Sports, Children/Youth, Education, Lifestyle, Drama, Undefined/Unsupported.
 If you select All Services, all channels are displayed in the left hand column.
- 5 Press the **Up/Down** buttons to select the desired programme.
- 6 Press the **Red** button to move the highlight between the left and right-hand columns.
- 7 Pressing the **Green** button will display the detailed programme information for the currently highlighted programme. Press the **Green** button again to hide the detailed programme information and display the programme listing.

Edit Favourite Channel Groups

You can add, rename and edit user profiles which contain groups of favourite channels.

- 1 Press **EPG** (EPG) button **two times** and the **DTV EPG Profile Menu** appears.

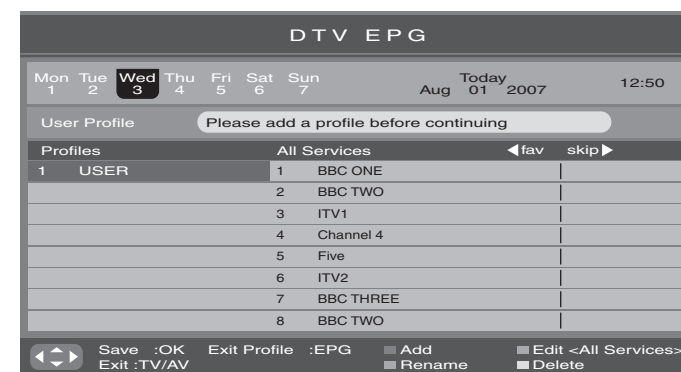

- 2 Press the **Red** button to add a user profile and the **Profile renaming** menu is displayed.

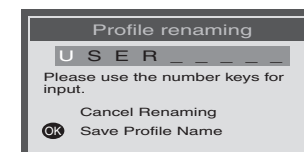

Use the numerical buttons to select the letters for the profile name. Press the number button as often as necessary to select the required letter.

Press the **Left/Right** buttons to move the cursor from letter to letter.

Press the **Blue** button cancel Profile renaming.

Press the **OK** (OK) button to save Profile Name.

Continued on page 32

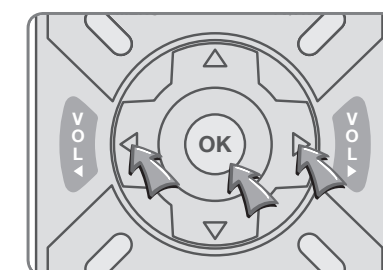
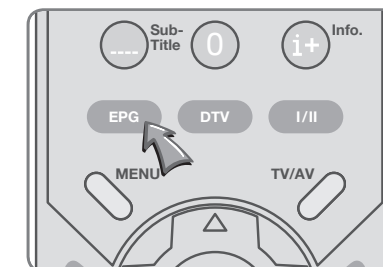

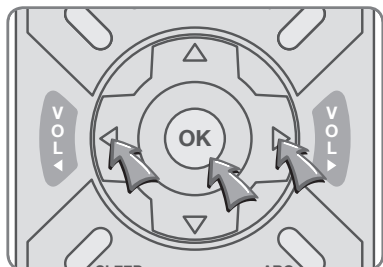

Edit Favourite Channel Groups – continued

3 Press the **Green** button to edit <All Services>.

Use the ◀▶ buttons to include the channel as a favourite or exclude it from the list.

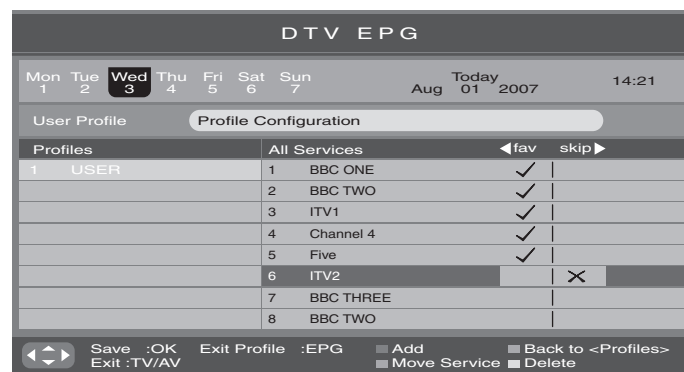

4 Press the **Blue** button to display the favourite channel list so that the channels can be arranged in their preferred order.

5 To change the order of favourite channels.

Highlight the channel that you want to move with the ▲▼ buttons and press the ◀ button to select the channel. The channel name will go grey to show it has been selected.

6 Use the ▲▼ buttons to choose a new position for the selected channel and press the ◀ button to insert the channel in its new position in the list.

Press the ▶ button to cancel moving a channel that has been selected.

7 Press the **TV/AV** (TV/AV) button to return to normal TV viewing.

When user profiles have been defined they can be accessed by pressing the **PROFILE** button when the General Programme Information banner is displayed.

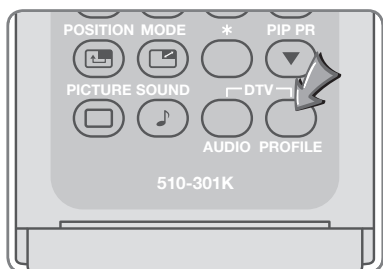
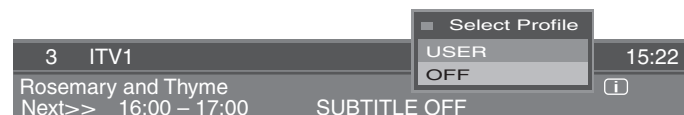

You can adjust Colour Temperature, Contrast, Brightness, Colour and Sharpness to the levels you prefer.

Manual Picture Control

1 Press the **MENU** (MENU) button.

2 Press the ▲▼ buttons to select the **Picture** menu and then press the ▶ button.

3 Select **Colour Temperature** using the ▶ button.

4 Press the ▲▼ buttons to select a particular colour tone.

If you select **User** you can control the value manually. Press the ◀▶ buttons to select the colour (R, G or B) to adjust and press the ▲▼ buttons to adjust the value.

Press the ◀▶ buttons until no colour is selected.

5 Press the **MENU** (MENU) button to return to the previous menu.

6 Press the ▲▼ buttons to select a picture item;

Contrast, Brightness, Colour or Sharpness.

7 Press the ◀▶ buttons to adjust the picture setting to your requirement as shown in the table below.

8 Press the **TV/AV** (TV/AV) button to store your personal preferences in **User**.

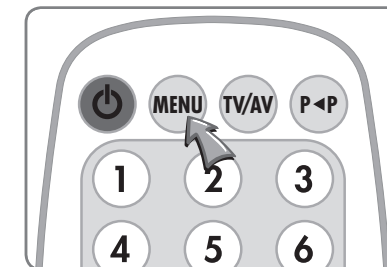

Main Menu

- Picture ▶
- Sound ▶
- Special ▶
- Setup ▶

Picture

- Colour Temperature ▶
- Contrast 75
- Brightness 65
- Colour 75
- Sharpness 80

Colour Temperature

- Standard
 - Reddish
 - Greenish
 - Bluish
 - User
-

Selected Item	Setting Change
Contrast	Less Contrast ◀ 0-100 ▶ More Contrast
Brightness	Darker ◀ 0-100 ▶ Brighter
Colour	Lower Colour Intensity ◀ 0-100 ▶ Higher Colour Intensity
Sharpness	Soft picture ◀ 0-100 ▶ Sharp Picture

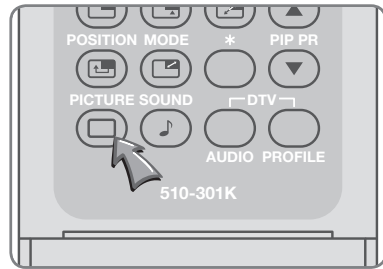

Picture Control



Auto Picture Control

The Picture options – Dynamic, Standard, Mild, and Game are programmed for optimum picture reproduction at the factory and cannot be changed.

Picture Effect

- 1 Press the **PICTURE** () button on the full function remote control.
- 2 Press the  button repeatedly. Each press of the button changes the screen display as below:



- Dynamic: Vivid Picture.
- Standard: Standard Picture.
- Mild: Softer Picture.
- Game: External Video Game Picture Setup.
- User: Manual Picture Setup.















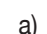
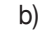
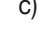

After a short time the display will clear leaving the setting as chosen.

Sound Control

Manual Sound Control

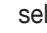
The **Equalizer** can be manually adjusted by cutting and boosting the five selected frequency bands and storing the settings as **User**.

The left to right **Balance** can be adjusted and if **AVL** is switched on there will be a more equal volume level between programmes.

- 1 Press the **MENU** () button.
- 2 Press the  buttons to select the **Sound** menu, and then press the  button.
- 3 Press  buttons to select the desired sound item; **Equalizer**, **Balance**, **AVL** or **SRS WOW**.
- 4 Press the  buttons to make desired adjustment.
- 5 Press the  buttons in **Equalizer** to set the Equalizer.
- 6 Press the  buttons to select the preferred setting; **Flat**, **Music**, **Movie**, **Speech** or **User**. To set the **Equalizer**:
 - a) Select **User** by pressing the  buttons.
 - b) Select a sound band by pressing the  buttons.
 - c) Make the desired sound level adjustment with the  buttons.
 - d) Press the **MENU** () button to return to the last menu, or the **TV/AV** () button to return to normal TV viewing.
- 7 Press the  buttons to select **Balance** and adjust the left to right balance with the  buttons.
- 8 Select **AVL** with the  buttons and use the  buttons to select **ON** or **OFF**.
- 9 Select **SRS WOW** with the  buttons and use the  buttons to select **ON** or **OFF**.
- 10 Press the **MENU** () button to return to the preceding menu or the **TV/AV** () button to return to normal TV viewing.

 The benefits of **SRS WOW** sound are enormous – you can be completely enveloped in sound.

The Equaliser menu is not available when **SRS WOW** is set to On.

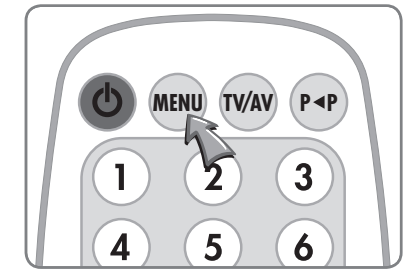

Main Menu

Picture	▶
Sound	▶
Special Setup	▶

Sound

Equalizer	▶
Balance	0
AVL	Off
SRS WOW	On

Equalizer

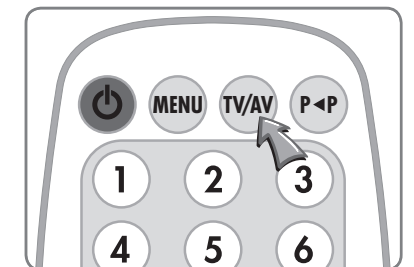
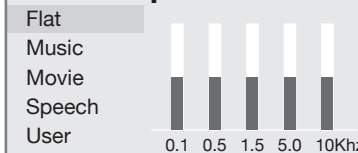

Sound Control

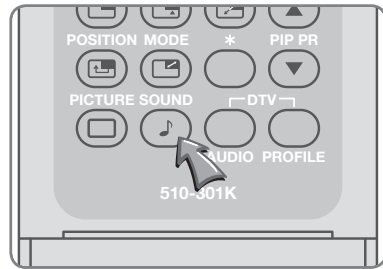

Auto Sound Control

The sound settings for **Flat**, **Music**, **Movie**, **Speech**, and **SRS WOW** are programmed at the factory for optimum sound reproduction, and cannot be changed.

Sound Effect

- 1 Press the **SOUND** (🎵) button on the full function remote control.
- 2 Press the **SOUND** (🎵) button repeatedly to select a setting.

Each press of the button changes the setting as below.



After a short time the display will clear leaving the setting as chosen.

Sound Output Selection



👉 The **I/II** button is only on the full function remote control.

In **DTV** and **AV** modes you can select output sound for the left and right speakers.

Repeatedly press the **I/II** (I/II) button to select the sound output.

L+R: Audio signal from audio L input is sent to the left speaker and audio signal from audio R input is sent to the right speaker.

L+L: Audio signal from audio L input is sent to the left and right speakers.

R+R: Audio signal from audio R input is sent to the left and right speakers.

Mono Sound Selection

If the signal is weak in **TV** mode, switch to mono by pressing the **I/II** (I/II) button twice on the standard full function remote control. Listening in mono will reduce noise in comparison with poor stereo reception.

Press the **I/II** (I/II) button twice again to switch back to stereo.

Clock Functions

The clock can only be set in **TV** mode.

Setting the clock is necessary in order to use the various timer features of the TileVision®. You can set automatic On or Off time.

- 1 Press the **MENU** (MENU) button.
- 2 Press the **▲▼** buttons to select the **Setup** menu and press the **▶** button to enter the **Setup** menu.
- 3 Press the **▲▼** buttons to select **Clock** menu and press the **▶** button to enter the **Clock** menu.

Press the **▲▼** buttons to select the item you want to adjust and press the **◀▶** buttons until the figures you want to adjust are highlighted in red. Highlighted figures can be adjusted using the **▲▼** or number buttons.
- 4 The present time must be set for any time function to work correctly. Store a time value between 00:00 and 23:59 (hours:minutes).
- 5 Press **TV/AV** (TV/AV) button to return to normal TV viewing.

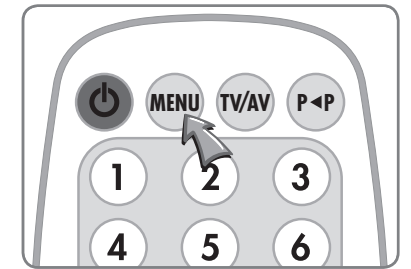

Main Menu

Picture	▶
Sound	▶▶
Special	▶▶▶
Setup	▶▶▶▶

Setup

Auto programme	▶
Manual programme	▶▶
Programme edit	▶▶▶
Clock	▶▶▶▶
Language	▶▶▶▶▶

Setup Clock

Clock	--:--	
Off Time	--:--	Off
On Time	--:--	Off
On Programme	--:--	1
On Volume	--:--	30

Other Functions

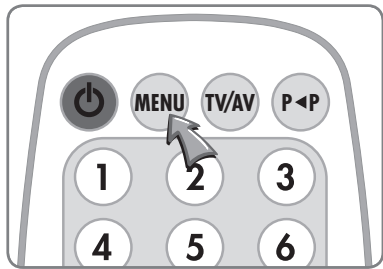

Main Menu

Picture	▶
Sound	▶▶
Special	▶▶▶
Setup	▶▶▶▶

Special

N.R.	Mode2
Blue Back	On
Auto Sleep	Off
Child Lock	Off
ARC	Auto

If the TileVision® connects with an external input source during the ten minutes after a TV programme stops, the Auto Sleep function is automatically cancelled.

Noise Reduction (N.R.)

The N.R. feature may improve the picture quality on poor broadcasts. If you experience noise on a certain programme, setting the N.R. to Mode1 or Mode2 for this programme may greatly improve the picture.

- 1 Press the **MENU** (MENU) button and press the ▲▼ buttons to select the **Special** menu. Press the ► button to enter the **Special** menu.
- 2 Press the ◀▶ buttons to select the N.R. options: **Mode1**, **Mode2**, or **Off**.
- 3 Press **TV/AV** (TV/AV) button to return to normal TV viewing.

Blue Back (TV mode only)

If no signal is being received or the signal is very weak, a blue screen automatically replaces the noisy picture background.

If you wish to continue viewing the poor picture, you must select to turn Blue Back Off.

Pressing the ◀▶ buttons will alternate between On and Off.

Auto Sleep (TV mode only) and Sleep Timer

If you select Auto Sleep, the TileVision® will automatically switch to standby approximately ten minutes after current channel stops broadcasting.

- 1 Press the **MENU** (MENU) button and press the ▲▼ buttons to select the **Special** menu. Press the ► button to enter the **Special** menu.
- 2 Press the ▲▼ buttons to select **Auto Sleep**.
- 3 Press the ◀▶ buttons to select **On** or **Off**.
- 4 Press **TV/AV** (TV/AV) button to return to normal TV viewing.

The sleep timer function is only available by pressing the **SLEEP** button on the full function standard remote control.

Press the **SLEEP** button repeatedly to select the number of minutes. The display will appear on the screen – select **0**, **15**, **30**, **60**, **120** minutes.

The sleep timer automatically switches the TileVision® off after the preset time elapses.

To view remaining sleep time press the **SLEEP** button once. To cancel the sleep time, Select 0 with the **SLEEP** button.

Child Lock

This function is not applicable to TileVision.

Aspect Ratio Control (ARC)

If ARC is set to Auto, the TileVision® will alter the picture to best suit the programme being received and there will be little need to change the setting manually.

TileVision can be viewed in six picture formats by repeatedly pressing the **ARC** button on the full function remote control until the desired image is selected.



Alternatively, the waterproof remote control can be used to alter the ARC setting via the **Special** menu.

- 1 Press the **MENU** (MENU) button and press the ▲▼ buttons to select the **Special** menu. Press the ► button to enter the **Special** menu.
- 2 Press the ▲▼ buttons to select **ARC**.
- 3 Press the ◀▶ buttons to select the required ARC setting.
- 4 Press **TV/AV** (TV/AV) button to return to normal TV viewing.

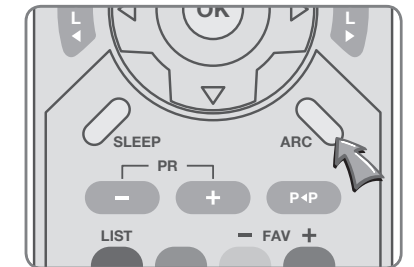

Special

N.R.	Mode2
Blue Back	On
Auto Sleep	Off
Child Lock	Off
ARC	Auto

How ARC settings alter the picture

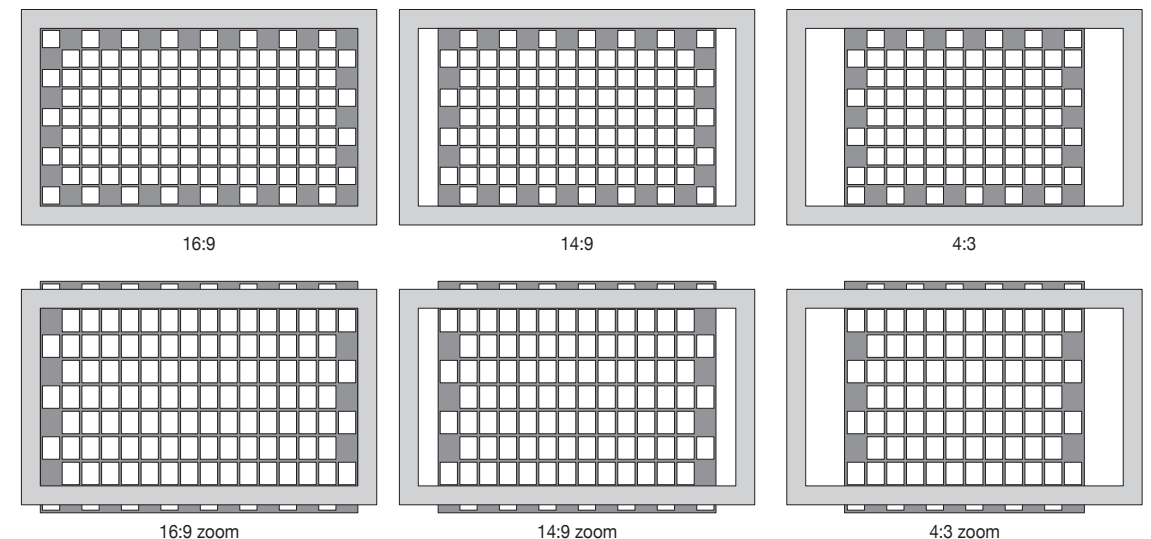

In Zoom mode, you can adjust the vertical position of the picture with the PR▲PR▼ buttons whilst the ARC information is displayed on screen.

In HDMI mode the zoom settings are not available.

The Programme List

Analogue TV Programmes stored in the memory can be checked by displaying the programme LIST.

Programme List

P001-----	P011-----
P002-----	P012-----
P003-----	P013-----
P004-----	P014-----
P005-----	P015-----
P006-----	P016-----
P007-----	P017-----
P008-----	P018-----
P009-----	P019-----
P010-----	P020-----

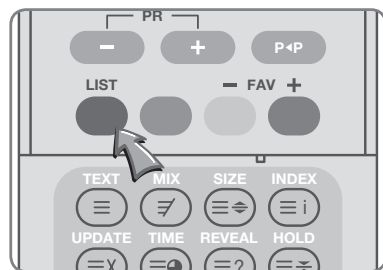
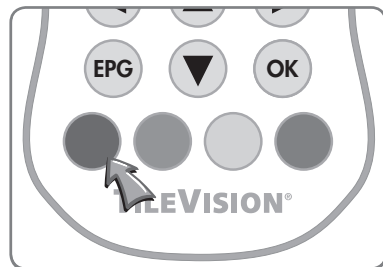

Displaying the Programme List

Press the **RED** button to display the programme list menu.

The programme list appears on the screen. Each programme list contains 20 programmes.

Selecting a programme in the Programme List

Select a programme with the **▲▼** or **◀▶** buttons. Then press the **OK** button. The set switches to the chosen programme.

Paging through the Programme List

There are 5 programme table pages giving a total of 100 programmes. Pressing the **▲▼** or **◀▶** buttons repeatedly turns the pages.

DTV Text

DTV Text (MHEG-5 standard) is only available in Great Britain, Ireland and New Zealand.

To access DTV Text press the **TEXT** (TEXT) or **Red** button depending on the programme's broadcaster. A small banner 'loading...' will be displayed on screen. After a few seconds the broadcaster's menu will appear, either overlaying part of the current programme:



Typical overlay example

or with the current programme in a smaller window next to the text menus and instructions:

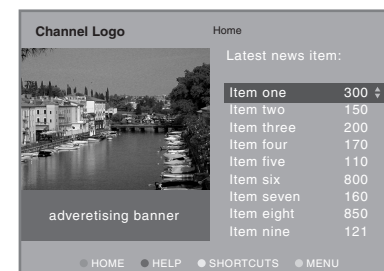

Typical inset example

Use the **▲▼** buttons (or in some cases the **◀▶** buttons) to navigate the menus and the **OK** (OK) button to select items. Use the **Red, Green, Yellow** and **Blue** buttons to access shortcuts, help and additional menus etc., as shown on screen.

To exit DTV Text press the **TEXT** (TEXT), the **TV/AV** (TV/AV) button or change channel.

As all DTV Text navigation uses the **▲▼◀▶**, **OK**, **Colour** and **0-9** number buttons, all functions are available with the TileVision® waterproof remote control.

If you press the **TEXT** (TEXT) button immediately after changing channel you may see the screen display as below:

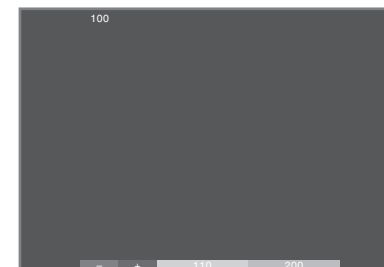

This is because the TileVision® had not had time to load any text information. Press the **TEXT** (TEXT) button again, wait a couple of seconds and try again.

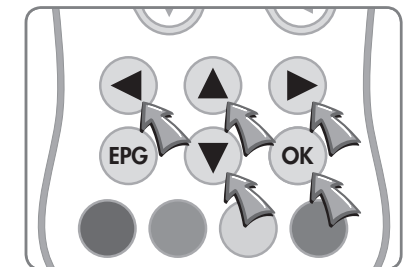
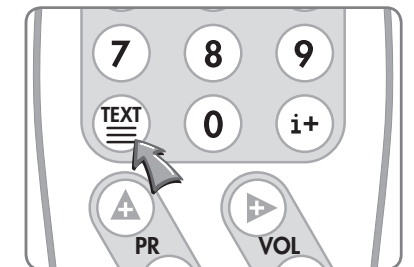

Some broadcasters show a red on-screen prompt when DTV Text is available.

To remove the prompt from the screen press the Green button.

Analogue TV Teletext

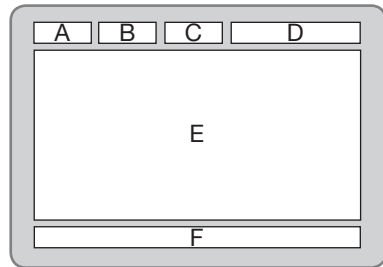

Functions of Teletext

- Part* *Display Contents*
- A Selected page number.
 - B Broadcast Station identity.
 - C Current page number or searching status.
 - D Date and time.
 - E Text information.
 - F FasText information.
Red, Green, Yellow, Blue

Displaying the Teletext Information

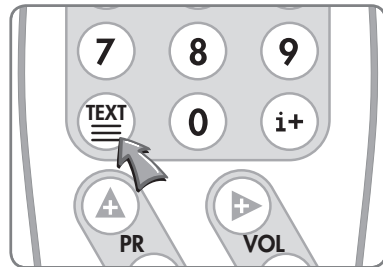

- 1** Press the **TEXT** (☰) button once to display the Teletext pages.
- 2** Use the **0-9** number buttons and the **Red, Green, Yellow** and **Blue** FastText buttons to navigate the text pages.
- 3** Press the **TEXT** (☰) button again to switch Teletext off and return to normal viewing.

The waterproof remote control does not include any 'extended' Teletext functions. To use all of the Teletext options, the buttons beneath the sliding cover on the full function remote control must be used.

Teletext Button Functions

The table below gives a complete explanation of each of the Teletext buttons on the full function remote control.

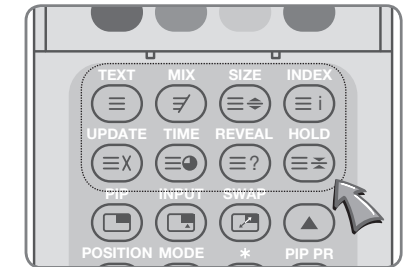

Button	Menu	Functions
	TEXT	Press the button to turn Teletext on or off.
	MIX	In Teletext mode – press the button to superimpose the text page over the TV picture, press again for normal Teletext mode.
	SIZE	Selects double height text. Press button to enlarge top half of the page. Press again to enlarge the bottom half of the page. Press again to return to normal size text.
	INDEX	Press to return to the index page.
	UPDATE	Displays the TV picture on the screen while waiting for the new Teletext page. The display will appear at the top left hand corner of the screen. When the updated page is available then the display will change to the page number. Press the UPDATE button to view the updated Teletext page.
	TIME	When viewing a TV programme, press this button to display the time at the top right hand corner of the screen. Press the button again to remove the display. In Teletext mode press this button to select and hold or change a four digit sub page number. This is displayed along the bottom of the screen. Press the button again to exit this function.
	REVEAL	Press this button to display concealed text, such as answers to quiz games. Press the button again to remove the information from the display.
	HOLD	Stops the automatic page change, which occurs if a Teletext page consists of two or more sub pages. Stop symbol is displayed in the top left hand corner of the screen. Press the button again to resume.

Troubleshooting

No picture or sound.	<ul style="list-style-type: none"> Make sure the AC power cord is connected to the power adaptor. Make sure the DC power cord is connected to the TileVision®. Check for power failure. If the red indicator is not showing press the POWER (⏻) button on the remote control
Screen is black.	<ul style="list-style-type: none"> Make sure the external signal source mode is selected. Press the signal input button TV/AV (TV/AV) to change to TV.
Picture is OK but there is no sound.	<ul style="list-style-type: none"> Press the Mute (🔇) button on the full function remote control. Check another channel. Press the button to increase the volume. Check the speaker connections from the TileVision® to the speakers.
Poor sound quality.	<ul style="list-style-type: none"> Make sure the channel is broadcasting in stereo. Press the I/II button to Select Mono. The sound quality of a stereo broadcast may be poor in a weak signal area. (See Sound Output Selection on page 36)
No image on a specific channel.	<ul style="list-style-type: none"> Make sure the channel selection is correct. Change the antenna direction to the right or left. Adjust the fine tuning of the channel.
Image is not stable and may appear to vibrate, horizontal bars appear.	<ul style="list-style-type: none"> Adjust the fine tuning of the channel. Make sure there is no powerful electromagnetic wave interference from the transmitting station. Stop using a hair drier, electric drill or electric blender.
No colour on a specific channel (a black & white image).	<ul style="list-style-type: none"> Check other channels to see if the specific channel is broadcasting a black & white program. Adjust the colour. (See page 33)
Black or white dots appear on all channels or a specific channel.	<ul style="list-style-type: none"> Make sure the antenna is connected correctly. (See page 7) Make sure the status of the antenna or wire is good. Adjust the fine tuning of the channel.

Specifications

Model	TV/17/FR5/PS	TV/23/FR3/PS
External Dimensions (W x H x D)	483 mm x 353 mm x 75 mm	630 mm x 450 mm x 90 mm
Total Weight complete with back box	12 Kg	16 Kg
Power	Requirements	12 VDC/6.67 A
	Consumption	72 W max, standby below 3 W
	AC/DC Power Adaptor	Input 100–240 VAC 50/60 Hz Output 12 VDC/6.67 A
System	Analog	PAL-BG, I, DK/SECAM-BG, DK, L
	Digital	DVB-T (MHEG) MPEG-2 decoding
TV	Programme	VHF:2–13 UHF 21–69 Cable S1–S41 FVS 100 programme (Analog)
	Programme	VHF:2–13 UHF 21–69 Cable S1–S41 FVS 100 programme (Analog)
LCD	Size Diagonal	17" (434.34 mm) Widescreen (16:9)
	Resolution/Pixel no.	WXGA (1280 x 768)
	Type	a-si TFT active matrix
	Brightness	550 cd/m ²
	Contrast Ratio	600:1
	Viewing Angle	L/R/U/D 89°/89°/89°/89°
	Colour Depth	16.7 M colours
Response Time	12 ms (Typ)	
External Antenna Impedence	VHF/UHF at 75 Ohm	VHF/UHF at 75 Ohm
Audio Output	5W + 5W rms (both channels driven)	5W + 5W rms (both channels driven)
	Nicam, A2 Stereo	Nicam, A2 Stereo
	Graphic Equaliser	Graphic Equaliser
OSD	Programme list/edit	Programme list/edit
	Menu – multi-language – halftone	Menu – multi-language – halftone
Connection Ports	12 VDC/6.67 A	24 VDC/5.42 A
	HDMI	HDMI
	AUDIO (L & R)	AUDIO (L & R)
	EURO-SCART (Full)	EURO-SCART (Full)
	S-VIDEO	S-VIDEO
	ANTENNA/TUNER (Co-axial)	ANTENNA/TUNER (Co-axial)
	Speakers (clip terminals)	Speakers (clip terminals)
Supplied Loudspeakers	External, Waterproof, 8Ω	External, Waterproof, 8Ω
Functions	Auto Programme	Auto Programme
	Manual Programme	Manual Programme
	ACMS (Auto Channel Memory System)	ACMS (Auto Channel Memory System)
	PSM (Picture Status Memory)	PSM (Picture Status Memory)
	SSM (Sound Status Memory)	SSM (Sound Status Memory)
	SRS WOW	SRS WOW
	AVL (Auto Volume Leveller)	AVL (Auto Volume Leveller)
	ARC (Aspect Ratio Control)	ARC (Aspect Ratio Control)
	Teletext – TOP/FLOF/MHEG-5	Teletext – TOP/FLOF/MHEG-5

👉 Design and specifications are subject to change without notice.



PORTER LANCASTRIAN LIMITED
www.tilevision.tv